

Schweißbrenner/ Welding torch / Torche de soudage /
Torcia per saldatura / Antorcha

CastoPlus 505 W



Ersatzteilliste

DE

Spare parts list

EN

Liste des pièces de rechange

FR

Lista parti di ricambio

IT

Lista de repuestos

ES



WELDING

Düsenstock / Tip holder / Support tube contact / Sippoerto ugello porta corrente / Porta-puntas de contacto



302301*	302335
Kurz / Short / Petit / Corto / Corta	Lang / Long / Long / Lungo / Larga

Gasverteiler / Gas diffusor / Diffuseur / Diffusore gas / Difusor

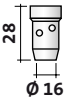

303820*	302300
Keramik / Ceramics / Céramique / Ceramica / Car mico	Kunststoff / Plastic / Pastique / Plastica / Pl stico

Kontaktdüse / Contact tip / Tube contact / Ugelli porta corrente / Punta contacto

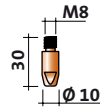
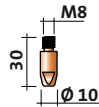

Cu (10 pcs.)	Cu (20 pcs.)
302334 ø 0,8	402334 ø 0,8
302332 ø 1,0	402332 ø 1,0
302299* ø 1,2	402299 ø 1,2
302330 ø 1,6	402330 ø 1,6
302394 ø 2,0	402394 ø 2,0
302395 ø 2,4	402395 ø 2,4

Beutel 10 Stk. / Bag with 10 pcs. / Sachet 10 u. / Confezione da 10 pz. / Bolsa 10 ud.

Beutel 20 Stk. / Bag with 20 pcs. / Sachet 20 u. / Confezione da 20 pz. / Bolsa 20 ud.

Al (10)	Al (20)
302333 ø 1,0	402333 ø 1,0
302327 ø 1,2	402327 ø 1,2
302331 ø 1,6	402331 ø 1,6

CuCrZr (10)	CuCrZr (20)
302663 ø 0,8	402663 ø 0,8
302662 ø 1,0	402662 ø 1,0
302659 ø 1,2	402659 ø 1,2
302658 ø 1,6	402658 ø 1,6

Gasdüse / Gas nozzle / Buse / Ugelli gas / Tobera

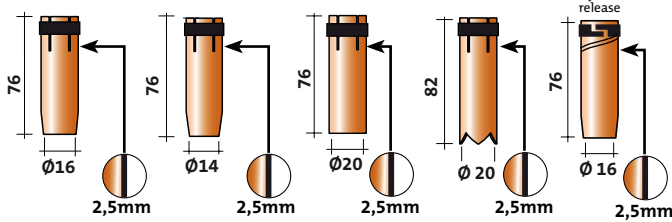

302298	302453	302325	302326	762484*
---------------	---------------	---------------	---------------	----------------

Brenner / Torches / Torches / Torce / Antorchas

Artikelnummer (ESC) / Article number (ESC) / N° de produit (ESC) / Codice (ESC) / Referencia (ESC)

CastoPlus 505 W - 3 m	762428
CastoPlus 505 W - 4 m	762429
CastoPlus 505 W - 5 m	762430

Technische Daten / Technical Data / Caracteristiques techniques / Dati tecnici / Caracteristicas técnicas

ED / Amp / 100% d.c. / f.de m.	500 A CO ₂ • 450 A Ar+CO ₂
Draht / Wire / Fil D mm / Filo Ø mm / Hilo	0,8 / 1,0 / 1,2 / 1,6 / 2,0 / 2,4
Kühlung / Cooling / Refroidissement / Raffreddamento / Refrigeración	Wasser / water / eau / acqua / agua
Spannungsklasse / Voltage class / Classe voltage / Classe tensione / Clase voltaje	L

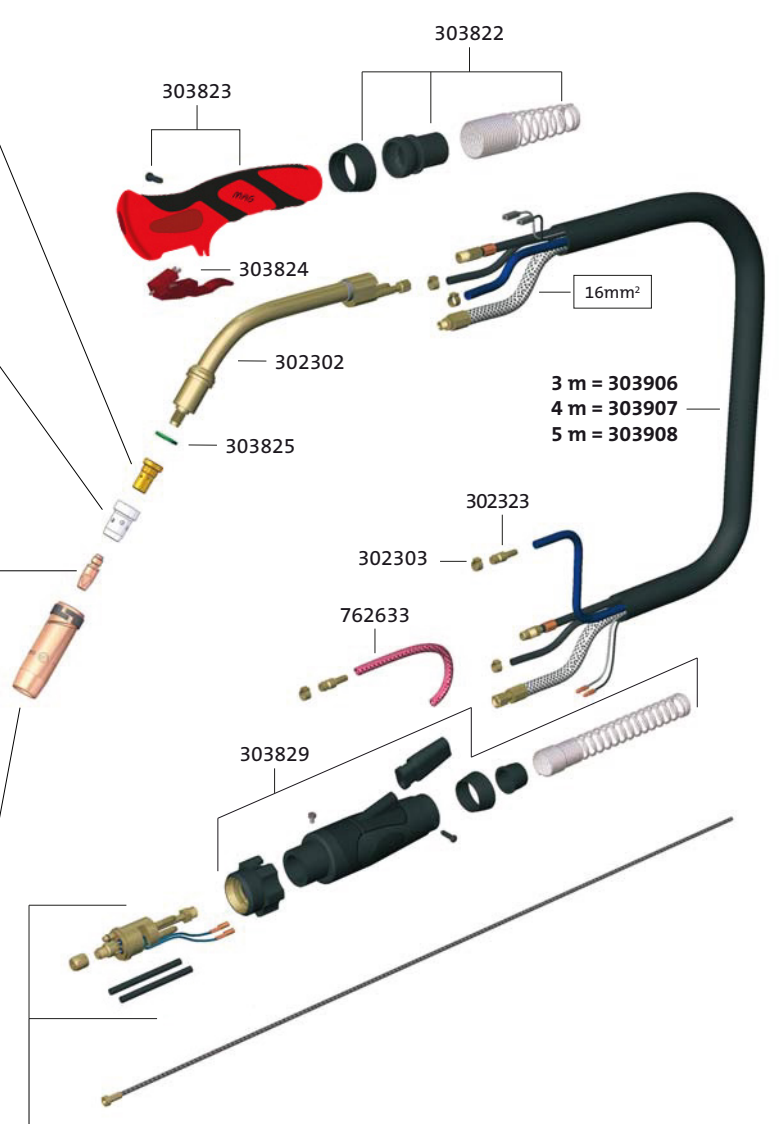

Euro ZA / Euro central connector / Raccord Euro / Euro connettore / Euro conector

303947	302238	302321
2 Stecker / 2 Pins / 2 Plots / 2 Pin / 2 Pines	O-Ring 4x1 / O-ring / Joint-torique / O-Ring / Junta torcia	Überwurfmutter / Retaining nut / Ecrrou-cloche / Dato per Euro connettore / Tuerca de retención

*** Standardausstattung / standard equipment / Equipement standard / Attrezzatura standard / Equipo standard**

Drahtseelen / Liners / Gaires / Guaine / Sirgas

	m	0,8-1,0	1,0-1,2	1,2-1,6	2,0-2,4
Stahl / Steel / Acier / Acciaio / Acero	3	302318	302340*	302344	302396
	4	302319	302341*	302345	302397
	5	302320	302342*	302346	302398
		Blau/blue/Bleu/ blu/Azul	Rot/red/Rouge/ rosso/rojo	Gelb/yellow/Jaune/ giallo/Amarillo	
Teflon / Teflon / Teflon / Teflon / Teflon	3	303830	303833	303836	
	4	303831	303834	303837	
	5	303832	303835	303838	
mit Spirale / with spiral / avec spirale / Con spirale / Terminal Acero	3		303840	303843	
	4		303841	303844	
	5		303842	303845	