

GO WITH SEAPLUS FOR YOUR SAFETY

FLAME DETECTOR

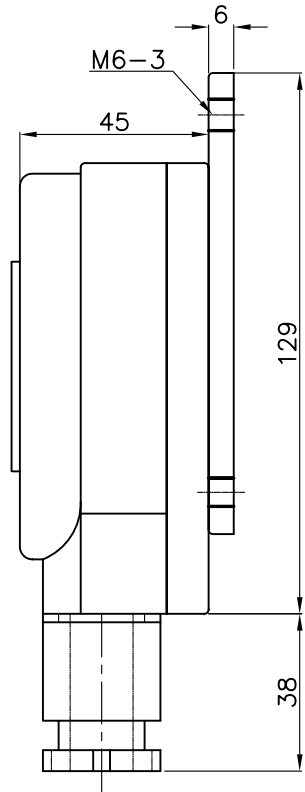
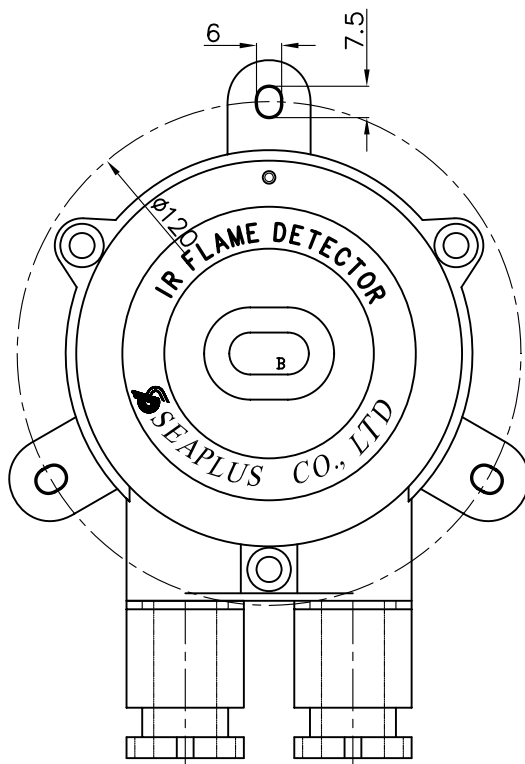

CABLE GLAND : JIS-15C

CONNECTION

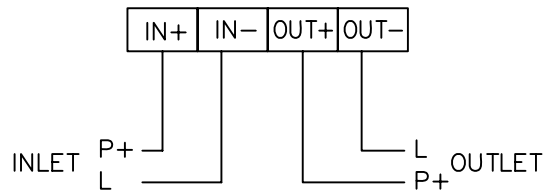

SPECIFICATIONS

- MODEL NO. : FD-IR-001
- MATERIAL : DIE-CASTING AL
- COLOR : IVORY (Munsell NO : 5Y9/1)
- OPERATING VOLTAGE : 18~24V DC
- QUIESCENT CURRENT : 6 mA
- ALARM CURRENT : 10 mA
- STABILIZATION TIME : 30 sec
- ANGLE OF INCIDENCE : 100°
- OPERATING TEMP. : -10°C ~ 50°C
- WEIGHT : About 1.1kg (DETECTOR + BASE)