

Elastomer Jaw Couplings

RINGFEDER® GWE 5112

Servo-Insert coupling with outer cone

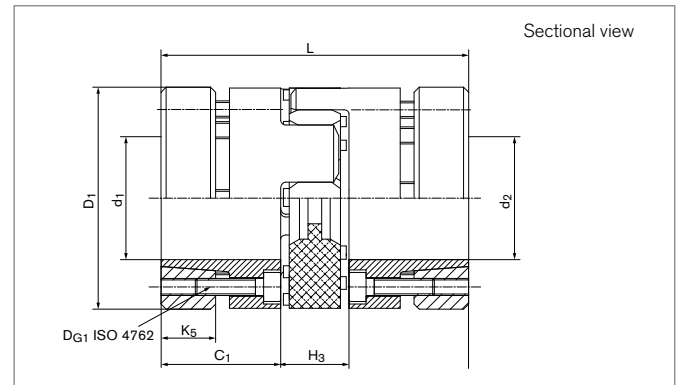

Size	d ₁ ;d ₂ min-max	C ₁	D ₁	H ₃	K ₅	L
	mm	mm	mm	mm	mm	mm
14	6 - 14	18,5	32	13	8	50
19	8 - 20	25	40	16	10	66
24	11 - 25	30	55	18	13	78
28	15 - 36	35	65	20	16	90
38	20 - 41	45	80	24	22	114
42	25 - 50	50	95	26	25	126
48	28 - 55	56	105	28	28	140

Transmission of the couplings transmissible torque T can not longer be guaranteed for certain with borings < d_{min}. Types with borings < d_{min}, however, can be supplied.

Moment of inertia and weight (mass) are calculated with reference to the largest bore size.

Size	T	H _{es}	n _{max}	J	Gw	DG ₁	T _{A1}
	Nm		1/min	10 ⁻³ kgm ²	kg	mm	Nm
14	12,5	98 SH A	25400	0,014	0,042	4 x M3	1,8
19	17	98 SH A	19000	0,063	0,158	6 x M4	3
24	60	98 SH A	13800	0,26	0,304	4 x M5	6
28	160	98 SH A	11700	0,63	0,505	8 x M5	6
38	325	98 SH A	9550	1,96	0,934	8 x M6	10
42	450	98 SH A	8050	6,43	3,8	4 x M8	35
48	525	98 SH A	7200	10,54	4,9	4 x M10	69

To continue see next page

Elastomer Jaw Couplings RINGFEDER® GWE 5112

Transmissible torque T [Nm]

Size	Transmissible torque																				
	Ø6	Ø10	Ø11	Ø13	Ø14	Ø15	Ø17	Ø19	Ø20	Ø24	Ø25	Ø27	Ø30	Ø32	Ø36	Ø38	Ø42	Ø44	Ø48	Ø50	Ø55
	Nm																				
14	3,6	9	12,5	12,5	12,5	---	---	---	---	---	---	---	---	---	---	---	---	---	---	---	---
19	---	17	17	17	17	17	17	17	17	---	---	---	---	---	---	---	---	---	---	---	---
24	---	---	22	37	46	56	60	60	60	60	60	---	---	---	---	---	---	---	---	---	---
28	---	---	---	---	---	56	68	114	134	160	160	160	160	160	160	---	---	---	---	---	---
38	---	---	---	---	---	---	---	---	134	230	261	325	325	325	325	325	---	---	---	---	---
42	---	---	---	---	---	---	---	---	---	---	260	329	450	450	450	450	450	450	450	450	---
48	---	---	---	---	---	---	---	---	---	---	---	---	326	450	525	525	525	525	525	525	525

Explanations

d₁;d_{2min} = Min. bore diameter d ₁ /d ₂	D₁ = Outer diameter	n_{max} = Max. rotation speed
d₁;d_{2max} = Max. bore diameter d ₁ /d ₂	H₃ = Length of damping module	J = Total moment of inertia
d_{1k};d_{2kmin} = Min. bore diameter d ₁ /d ₂ with keyway acc. to DIN 6885-1	K_S = Width of clamping ring	Gw = Weight
d_{1k};d_{2kmax} = Max. bore diameter d ₁ /d ₂ with keyway acc. to DIN 6885-1	L = Total length	D_{G1} = Thread
C₁ = Guided length in hub bore	T = Transmissible torque at given T _A	T_{A1} = Tightened torque of clamping screw D _{G1}
	H_{es} = Hardness of the elastomeric spider	

Ordering example

Series Size	Bore diameter d ₁	Bore diameter d ₂	Spider hardness (optional) ¹⁾	Spider bore d _{bz} (optional) ¹⁾
GWE 5112-42	32	41	64 SH D	42

¹⁾ If a different spider hardness is selected, the detailed technical data for the sprockets must be observed. See chapter „Elastomer Jaw Couplings RINGFEDER® GWE Technical description“ in Product Paper & Tech Paper „RINGFEDER® Elastomer Jaw Couplings“