

Cat. No. 047
Rev. 01 – 3/99

Culligan[®]

Aqua-Cleer[®]
MFP/3

PARTS LIST
1999 Line

MEDICAL DEVICES

CE

0373

Culligan reserves the right to change any technical or design specifications

**CULLIGAN ITALIANA S.p.A. - Via Gandolfi, 6 - 40057 Cadriano di Granarolo E. BO (ITALY) –
Phone +39/0516017111 – Telefax +39/051765602**

Quality System Certified according to UNI EN ISO 9001 Norm

Aqua-Cleer MFP/3 400 – 3-ph

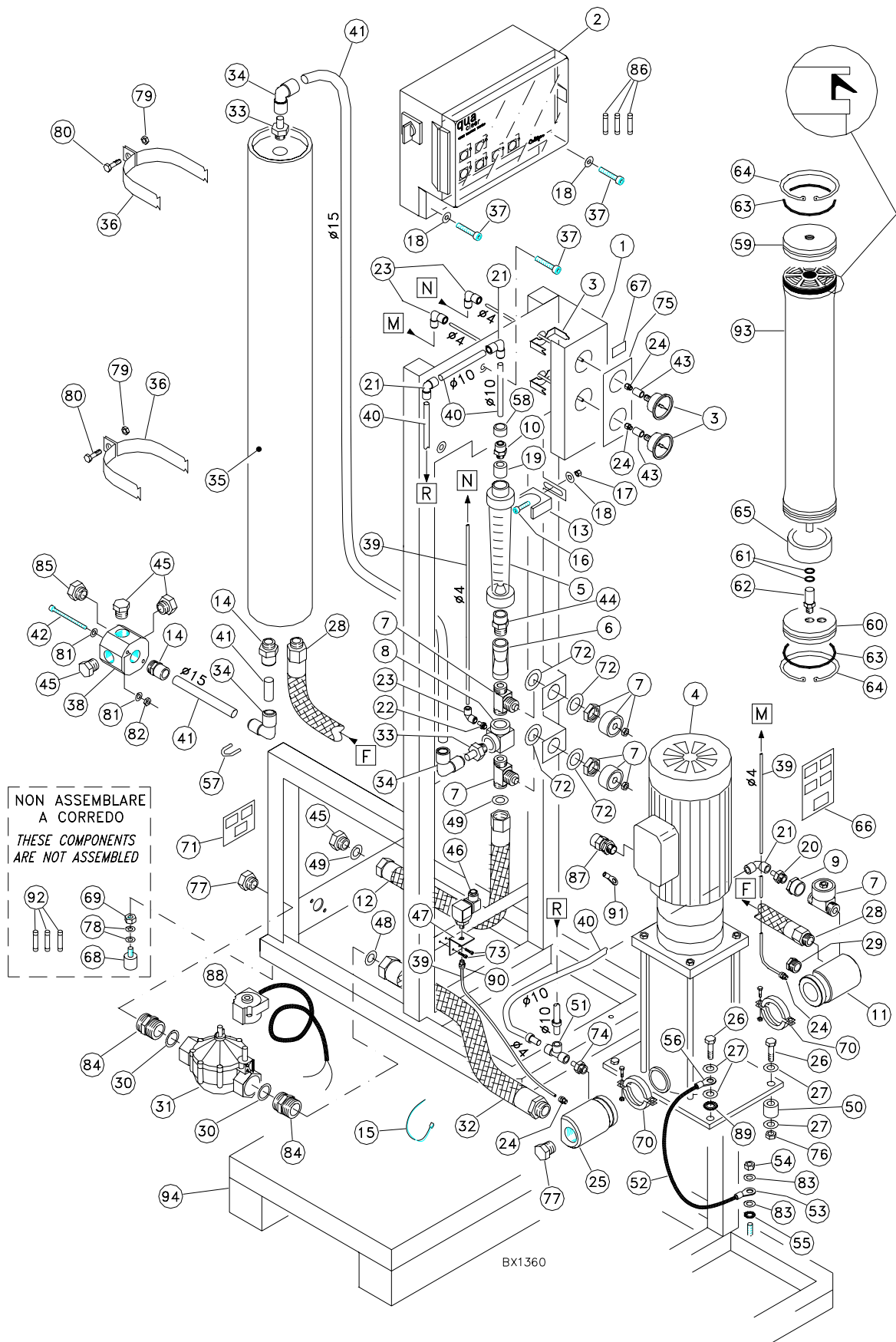

Aqua-Cleer MFP/3 400 – 3-ph

ITEM	DESCRIPTION	QTY	CAT. NO.	ITEM	DESCRIPTION	QTY	CAT.NO.
-	AQUA-CLEER MFP 400 230-380/50 3-PH C/MOD+GAB96 - CE	-	760914	48	GASKET 1" ASBESTOS FREE	1	753409
1	FRAME MFP/3 COATED STEEL	1	759769	49	GASKET 1/2" ASBESTOS FREE	2	753408
2	CONTROL PANEL MFP 220-240-380-415/50 3-PH	1	758990	50	SPACER OD26XID13 L19 PP	4	754069
3	PRESSURE GAUGE 0-25BAR OD63 REAR CONN 1/4" INOX	2	753492	51	EQUAL TEE T 10 PM0210E PL	1	751587
4	PUMP 2P CRN02-150 1.5kw 230/380-415/50- 60IP55	1	759616	52	WIRE 16 SQMM YELLOW/GREEN	0,2	747699
5	FLOW INDICATOR DFM185 100-1000 L/H DN20 PVC	1	753416	53	WIRE TERMINAL 16 SQMM A3-M8	1	734561
6	NON RETURN VALVE DELRIN 1/2" TYPE 290/D	1	752117	54	NUT HEX M8 316STST DIN934	1	932098
7	VALVE NEEDLE 1/2" SERTO ART 7200	3	780141	55	LOCK WASHER ID8 316STST DIN6798	1	932105
8	TEE SPEC 1/2"x1/4" 316STST	1	753299	56	WIRE TERMINAL 16 SQMM F12	1	753410
9	SOCKET REDUCED 1/4"x1/2" PL BRASS F2553	1	721002	57	LOCKING CLIP OD15 CM1815S PL	22	753311
10	STRAIGHT ADAPTER 1/4"BSPT-M X T10 PM011012 PL	1	751593	58	COLLET COVER OD10 PM1910S PL	8	753312
11	HEADER OUTL 1 1/2" 316STST RT MFP	1	757218	59	CAP END 1" 1 HOLE WASTE	1	440989
12	HOSE FLEX 1/2"x680 M/F STST BRAIDED	1	753414	60	CAP END 6/4" 2 HOLES FEED/PRODUCT	1	440990
13	PIPE CLIP PVC ID 025 REF 167.060.007	1	736129	61	O-RING ID 018.72/0.737" s2.62/0.103" BUNAN	2	736995
14	STRAIGHT ADAPTER 1/2"BSPT-M X T15 PM011514E PL	2	752112	62	ADAPTER 1/2"x19.2 MOPLEN	1	753469
15	STRIP POLYAMMIDE ID1.6-33 2.4X140	20	736256	63	O-RING ID 107.44/4.230" s5.34/0.210" BUNAN	2	933657
16	SCREW ALLEN M5X14 304STST DIN912	1	722322	64	SEGER ID120 THK 2.8 DACROMET 00933659	2	933659
17	NUT M5 304STST DIN934	1	746412	65	SPACER PVC OD110 L75	1	753471
18	WASHER 304STST ID5.3XOD10	3	744075	66	LABEL KIT (5 PCS)	1	753671
19	SUPPORT FLOW METER ND20 PVC MFP	1	753309	67	LABEL MFP400	1	759758
20	STEM ADAPTER 1/4" BSPT-M X T10 PM051012E PL	1	751594	68	VIBRATION ABSORBER RUBBER M6 OD25 P2520	4	737651
21	EQUAL ELBOW T10 PM0310E PL	3	751588	69	NUT SELF-LOCKING M6 316STST DIN982	4	722984
22	STEM ADAPTER 1/4" BSPT-M X T4 PM050412E PL	1	753313	70	CLAMP FCLC-S-48.3+OR+TDE M8X40 AISI316	2	758811
23	EQUAL ELBOW T4 PM0304E PL	3	753314	71	LABEL KIT (3 PCS)	1	755311
24	STRAIGHT ADAPTER 1/4" BSPT-M X T4 PM010412E PL	4	739161	72	WASHER BRASS 30X25X1.5 OT	4	780142
25	HEADER INL 1 1/2" 316STST RT MFP	1	757219	73	SCREW ALLEN M4X16 316STST DIN912	2	732871
26	SCREW	4	748783	74	STEM ADAPTER 3/8" T10 PM051013E PL	1	751763
27	WASHER 304STST ID13XOD24	9	716522	75	LABEL ADHESIVE PRESSURE GAUGES	1	759757
28	HOSE FLEX 1/2"x350 M/F STST BRAIDED ID16	1	753412	76	NUT HEX M12 316STST DIN934	4	W02218
29	PLUG HEX MALE 1/2" 316STST ART1137	1	W94110	77	PLUG MALE PVC 1" PFV	2	720563
30	O-RING ID 037.77/1.487" s2.62/0.109" BUNAN	2	773963	78	WASHER OD12.5XID6.4 304STST	8	732407
31	SOLENOID VALVE BODY 1"	1	780881	79	NUT HEX M10 316STST DIN934	2	724665
32	HOSE FLEX 1"x255 M/F STST BRAIDED ID25	1	753415	80	SCREW HEX M10X25 304STST DIN933	2	727410
33	STEM ADAPTER 1/2" BSPT-M X T15 PM051514E PL	2	752115	81	WASHER OD9XID4.3 316STST	4	718506
34	EQUAL ELBOW T 15 PM0315E PLAST	3	752114	82	NUT HEX M4 316STST DIN934	2	718048
35	PRESSUREURE VESSEL 4.6"x47" FRP 400 PSI 00440988	1	440988	83	WASHER OD17XID8.4 304STST	2	711890
36	COLLAR ID135 304STST PAIR 00441597	2	441597	84	NIPPLE BARREL PVC 1"	2	754933
37	SCREW ALLEN M5X25 316STST DIN912	3	726069	85	PLUG MALE PVC 3/4" PFV	1	720562
38	DISTRIBUTOR DELRIN FOR MFP	1	780013	86	FUSE 4A 10X38 DELAYED	3	780116
39	TUBE FLEX OD4XID2 HTR NP20 BLK FOOD GRADE	3	734808	87	CABLE GLAND SKINTOP PG16 C/W NUT AR53015040	1	757708
40	TUBE FLEX OD10XID8 HTR NP15 BLK FOOD GRADE	4	751770	88	COIL FOR SOLENOID VALVE BODY	1	780882
41	TUBE FLEX OD15XID12 HTR NP20 BLK FOOD GRADE	3	752116	89	LOCK WASHER ID12 316STST DIN6798	1	780360
42	SCREW HEX M4X60 304STST DIN84A	2	747616	90	STRAIGHT ADAPTER 1/8" BSPT-M X4MM PM010411E PL	1	751589
43	SOCKET 1/4" OD18 L=25MM 316STST	2	W92208	91	WIRE TERMINAL ROT ID5/1A 2.6SQMM 34106	4	720675
44	DOUBLE ADAPTER PVC 025X020X1/2" KIFV	1	950784	92	FUSE 8A 10X38 DELAYED	3	780118
45	PLUG MALE PVC 1/2" PFV	4	720561	93	MODULE RO FT-TW30-4641HP (DRY) GRP FINISH	1	781058
46	PRESSUREURE SWITCH 00.15-2A 1/8" OT PMN2AVTO.3D	1	780444	94	CASE 66X56X162 MFP-PHARMA	1	780517
47	PRESSURE SWITCH SUPPORT BRACKET 316STST	1	758393				

Aqua-Cleer MFP/3 800 – 3-ph

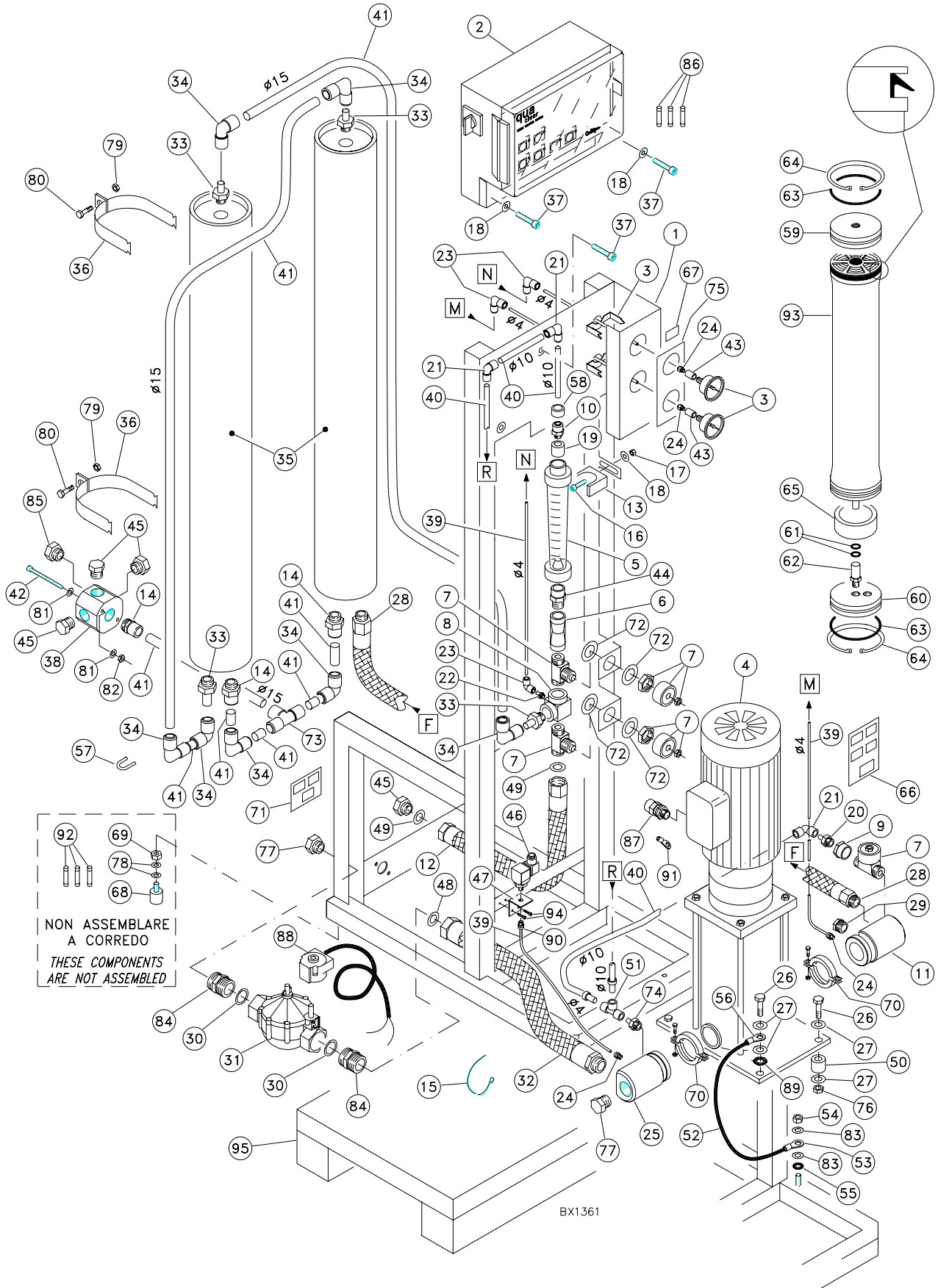

NON ASSEMBLARE
A CORREDO
THESE COMPONENTS
ARE NOT ASSEMBLED

BX1361

Aqua-Cleer MFP/3 800 – 3-ph

ITEM	DESCRIPTION	QTY	CAT.NO.	ITEM	DESCRIPTION	QTY	CAT.NO.
-	AQUA-CLEER MFP 800 230-380/50 3-PH C/MOD+GAB96 - CE	-	760915	48	GASKET 1" ASBESTOS FREE	1	753409
1	FRAME MFP/3 COATED STEEL	1	759769	49	GASKET 1/2" ASBESTOS FREE	2	753408
2	CONTROL PANEL MFP 220-240-380-415/50 3-PH	1	758990	50	SPACER OD26XID13 L19 PP	4	754069
3	PRESSURE GAUGE 0-25BAR OD63 REAR CONN 1/4" INOX	2	753492	51	EQUAL TEE T 10 PM0210E PL	1	751587
4	PUMP 2P CRN02-180 2.2KW220/380-415/50-60IP55	1	759617	52	WIRE 16 SQMM YELLOW/GREEN	0,2	747699
5	FLOW INDICATOR DFM185 100-1000 L/H DN20 PVC	1	753416	53	WIRE TERMINAL 16 SQMM A3-M8	1	734561
6	NON RETURN VALVE DELRIN 1/2" TYPE 290/D	1	752117	54	NUT HEX M8 316STST DIN934	1	932098
7	VALVE NEEDLE 1/2" SERTO ART 7200	3	780141	55	LOCK WASHER ID8 316STST DIN6798	1	932105
8	TEE SPEC 1/2"x1/4" 316STST	1	753299	56	WIRE TERMINAL 16 SQMM F12	1	753410
9	SOCKET REDUCED 1/4"x1/2" PL BRASS F2553	1	721002	57	LOCKING CLIP OD15 CM1815S PL	22	753311
10	STRAIGHT ADAPTER 1/4"BSPT-M X T10 PM011012 PL	1	751593	58	COLLET COVER OD10 PM1910S PL	8	753312
11	HEADER OUTL 1 1/2" 316STST RT MFP	1	757218	59	CAP END 1" 1 HOLE WASTE	2	440989
12	HOSE FLEX 1/2"x680 M/F STST BRAIDED	1	753414	60	CAP END 6/4" 2 HOLES FEED/PRODUCT	2	440990
13	PIPE CLIP PVC ID 025 REF 167.060.007	1	736129	61	O-RING ID 018.72/0.737" S2.62/0.103" BUNAN	4	736995
14	STRAIGHT ADAPTER 1/2"BSPT-M X T15 PM011514E PL	3	752112	62	ADAPTER 1/2"x19.2 MOPLEN	2	753469
15	STRIP POLYAMMIDE ID1.6-33 2.4X140	20	736256	63	O-RING ID 107.44/4.230" S5.34/0.210" BUNAN	4	933657
16	SCREW ALLEN M5X14 304STST DIN912	1	722322	64	SEGER ID120 THK 2.8 DACROMET 00933659	4	933659
17	NUT M5 304STST DIN934	1	746412	65	SPACER PVC OD110 L75	2	753471
18	WASHER 304STST ID5.3XOD10	3	744075	66	LABEL KIT (5 PCS)	1	753671
19	SUPPORT FLOW METER ND20 PVC MFP	1	753309	67	LABEL MFP800	1	759759
20	STEM ADAPTER 1/4" BSPT-M X T10 PM051012E PL	1	751594	68	VIBRATION ABSORBER RUBBER M6 OD25 P2520	4	737651
21	EQUAL ELBOW T10 PM0310E PL	3	751588	69	NUT SELF-LOCKING M6 316STST DIN982	4	722984
22	STEM ADAPTER 1/4" BSPT-M X T4 PM050412E PL	1	753313	70	CLAMP FCLC-S-48.3+OR+TDE M8X40 AISI316	2	758811
23	EQUAL ELBOW T4 PM0304E PL	3	753314	71	LABEL KIT (3 PCS)	1	755311
24	STRAIGHT ADAPTER 1/4" BSPT-M X T4 PM010412E PL	4	739161	72	WASHER BRASS 30X25X1.5 OT	4	780142
25	HEADER INL 1 1/2" 316STST RT MFP	1	757219	73	EQUAL TEE T 15 PM215E PLAST	1	752113
26	SCREW	4	748783	74	STEM ADAPTER 3/8" T10 PM051013E PL	1	751763
27	WASHER 304STST ID13XOD24	9	716522	75	LABEL ADHESIVE PRESSURE GAUGES	1	759757
28	HOSE FLEX 1/2"x350 M/F STST BRAIDED ID16	1	753412	76	NUT HEX M12 316STST DIN934	4	W02218
29	PLUG HEX MALE 1/2" 316STST ART1137	1	W94110	77	PLUG MALE PVC 1" PFV	2	720563
30	O-RING ID 037.77/1.487" S2.62/0.109" BUNAN	2	773963	78	WASHER OD12.5XID6.4 304STST	8	732407
31	SOLENOID VALVE BODY 1"	1	780881	79	NUT HEX M10 316STST DIN934	4	724665
32	HOSE FLEX 1"x255 M/F STST BRAIDED ID25	1	753415	80	SCREW HEX M10X25 304STST DIN933	4	727410
33	STEM ADAPTER 1/2" BSPT-M X T15 PM051514E PL	4	752115	81	WASHER OD9XID4.3 316STST	4	718506
34	EQUAL ELBOW T 15 PM0315E PLAST	7	752114	82	NUT HEX M4 316STST DIN934	2	718048
35	PRESSUREURE VESSEL 4.6"x47" FRP 400 PSI 00440988	2	440988	83	WASHER OD17XID8.4 304STST	2	711890
36	COLLAR ID135 304STST PAIR 00441597	4	441597	84	NIPPLE BARREL PVC 1"	2	754933
37	SCREW ALLEN M5X25 316STST DIN912	3	726069	85	PLUG MALE PVC 3/4" PFV	1	720562
38	DISTRIBUTOR DELRIN FOR MFP	1	780013	86	FUSE 6A 10X38 DELAYED	3	780117
39	TUBE FLEX OD4XID2 HTR NP20 BLK FOOD GRADE	3	734808	87	CABLE GLAND SKINTOP PG16 C/W NUT AR53015040	1	757708
40	TUBE FLEX OD10XID8 HTR NP15 BLK FOOD GRADE	4	751770	88	COIL FOR SOLENOID VALVE BODY	1	780882
41	TUBE FLEX OD15XID12 HTR NP20 BLK FOOD GRADE	3	752116	89	LOCK WASHER ID12 316STST DIN6798	1	780360
42	SCREW HEX M4X60 304STST DIN84A	2	747616	90	STRAIGHT ADAPTER 1/8" BSPT-M X4MM PM010411E PL	1	751589
43	SOCKET 1/4" OD18 L=25MM 316STST	2	W92208	91	WIRE TERMINAL ROT ID5/1A 2.6SQMM 34106	4	720675
44	DOUBLE ADAPTER PVC 025X020X1/2" KIFV	1	950784	92	FUSE 10A 10X38 DELAYED	3	780119
45	PLUG MALE PVC 1/2" PFV	4	720561	93	MODULE RO FT-TW30-4641HP (DRY) GRP FINISH	2	781058
46	PRESSUREURE SWITCH 00.15-2A 1/8" OT PMN2AVTO.3D	1	780444	94	SCREW ALLEN M4X16 316STST DIN912	2	732871
47	PRESSURE SWITCH SUPPORT BRACKET 316STST	1	758393	95	CASE 66X56X162 MFP-PHARMA	1	780517

Aqua-Cleer MFP/3 1200 – 3-ph

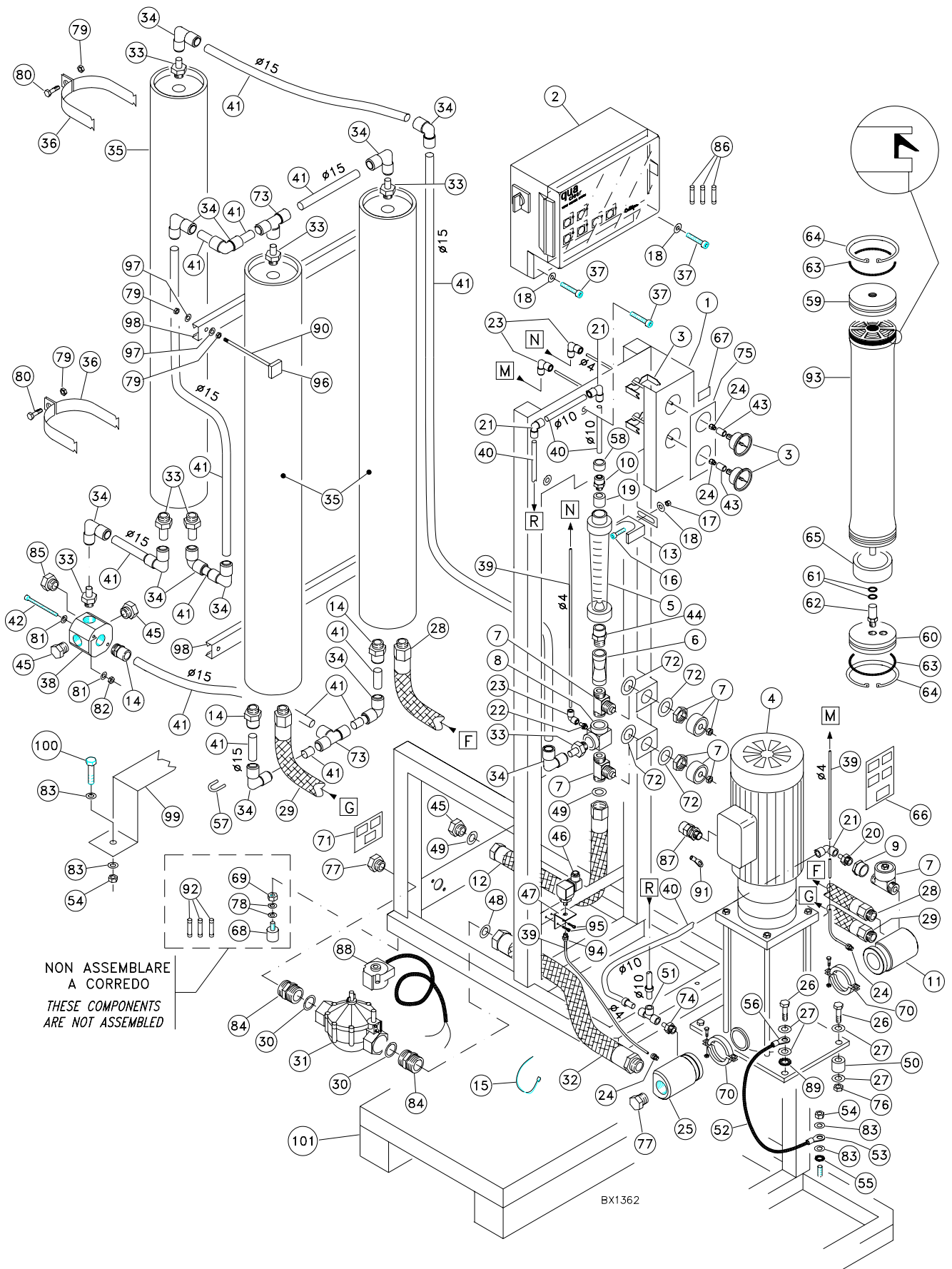

NON ASSEMBLARE
A CORREDO
THESE COMPONENTS
ARE NOT ASSEMBLED

Aqua-Cleer MFP/3 1200 – 3-ph

ITEM	DESCRIPTION	QTY	CAT.NO.	ITEM	DESCRIPTION	QTY	CAT.NO.
-	AQUA-CLEER MFP 1200 230-380/50 3-PH C/MOD+GAB96 - CE	-	760916	51	EQUAL TEE T 10 PM0210E PL	1	751587
1	FRAME MFP/3 COATED STEEL	1	759769	52	WIRE 16 SQMM YELLOW/GREEN	0,2	747699
2	CONTROL PANEL MFP 220-240-380-415/50 3-PH	1	758990	53	WIRE TERMINAL 16 SQMM A3-M8	1	734561
3	PRESSURE GAUGE 0-25BAR OD63 REAR CONN 1/4" INOX	2	753492	54	NUT HEX M8 316STST DIN934	3	932098
4	PUMP 2P CRN02-180 2.2kW 230/380-415/50-60IP55	1	759617	55	LOCK WASHER ID8 316STST DIN6798	1	932105
5	FLOW INDICATOR DFM185 100-1000 L/H DN20 PVC	1	753416	56	WIRE TERMINAL 16 SQMM F12	1	753410
6	NON RETURN VALVE DELRIN 1/2" TYPE 290/D	1	752117	57	LOCKING CLIP OD15 CM1815S PL	35	753311
7	VALVE NEEDLE 1/2" SERTO ART 7200	3	780141	58	COLLET COVER OD10 PM1910S PL	9	753312
8	TEE SPEC 1/2"x1/4" 316STST	1	753299	59	CAP END 1" 1 HOLE WASTE	3	440989
9	SOCKET REDUCED 1/4"x1/2" PL BRASS F2553	1	721002	60	CAP END 6/4" 2 HOLES FEED/PRODUCT	3	440990
10	STRAIGHT ADAPTER 1/4"BSPT-M X T10 PM011012 PL	1	751593	61	O-RING ID 018.72/0.737" S2.62/0.103" BUNAN	6	736995
11	HEADER OUTL 1 1/2" 316STST RT MFP	1	757218	62	ADAPTER 1/2"x19.2 MOPLEN	3	753469
12	HOSE FLEX 1/2"x680 M/F STST BRAIDED	1	753414	63	O-RING ID 107.44/4.230" S5.34/0.210" BUNAN	6	933657
13	PIPE CLIP PVC ID 025 REF 167.060.007	1	736129	64	SEEGER ID120 THK 2.8 DACROMET 00933659	6	933659
14	STRAIGHT ADAPTER 1/2"BSPT-M X T15 PM011514E PL	3	752112	65	SPACER PVC OD110 L75	3	753471
15	STRIP POLYAMMIDE ID1.6-33 2.4X140	20	736256	66	LABEL KIT (5 PCS)	1	753671
16	SCREW ALLEN M5X14 304STST DIN912	1	722322	67	LABEL MFP1200	1	759760
17	NUT M5 304STST DIN934	1	746412	68	VIBRATION ABSORBER RUBBER M6 OD25 P2520	4	737651
18	WASHER 304STST ID5.3XOD10	3	744075	69	NUT SELF-LOCKING M6 316STST DIN982	4	722984
19	SUPPORT FLOW METER ND20 PVC MFP	1	753309	70	CLAMP FCLC-S-48.3+OR+TDE M8X40 AISI316	2	758811
20	STEM ADAPTER 1/4" BSPT-M X T10 PM051012E PL	1	751594	71	LABEL KIT (3 PCS)	1	755311
21	EQUAL ELBOW T10 PM0310E PL	3	751588	72	WASHER BRASS 30X25X1.5 OT	4	780142
22	STEM ADAPTER 1/4" BSPT-M X T4 PM050412E PL	1	753313	73	EQUAL TEE T 15 PM215E PLAST	2	752113
23	EQUAL ELBOW T4 PM0304E PL	3	753314	74	STEM ADAPTER 3/8" T10 PM051013E PL	1	751763
24	STRAIGHT ADAPTER 1/4" BSPT-M X T4 PM010412E PL	4	739161	75	LABEL ADHESIVE PRESSURE GAUGES	1	759757
25	HEADER INL 1 1/2" 316STST RT MFP	1	757219	76	NUT HEX M12 316STST DIN934	4	w02218
26	SCREW	4	748783	77	PLUG MALE PVC 1" PFV	2	720563
27	WASHER 304STST ID13XOD24	9	716522	78	WASHER OD12.5XID6.4 304STST	8	732407
28	HOSE FLEX 1/2"x350 M/F STST BRAIDED ID16	1	753412	79	NUT HEX M10 316STST DIN934	10	724665
29	HOSE FLEX 1/2"x400 M/F STST BRAIDED ID16	1	753413	80	SCREW HEX M10X25 304STST DIN933	2	727410
30	O-RING ID 037.77/1.487" S2.62/0.109" BUNAN	2	773963	81	WASHER OD9XID4.3 316STST	4	718506
31	SOLENOID VALVE BODY 1"	1	780881	82	NUT HEX M4 316STST DIN934	2	718048
32	HOSE FLEX 1"x255 M/F STST BRAIDED ID25	1	753415	83	WASHER OD17XID8.4 304STST	6	711890
33	STEM ADAPTER 1/2" BSPT-M X T15 PM051514E PL	7	752115	84	NIPPLE BARREL PVC 1"	2	754933
34	EQUAL ELBOW T 15 PM0315E PLAST	12	752114	85	PLUG MALE PVC 3/4" PFV	1	720562
35	PRESSURE VESSEL 4.6"x47" FRP 400 PSI 00440988	3	440988	86	FUSE 6A 10X38 DELAYED	3	780117
36	COLLAR ID135 304STST PAIR 00441597	2	441597	87	CABLE GLAND SKINTOP PG16 C/W NUT AR53015040	1	757708
37	SCREW ALLEN M5X25 316STST DIN912	3	726069	88	COIL FOR SOLENOID VALVE BODY	1	780882
38	DISTRIBUTOR DELRIN FOR MFP	1	780013	89	LOCK WASHER ID12 316STST DIN6798	1	780360
39	TUBE FLEX OD4XID2 HTR NP20 BLK FOOD GRADE	4	734808	90	STUD FULL THREAD M10X150 L170	4	753406
40	TUBE FLEX OD10XID8 HTR NP15 BLK FOOD GRADE	4	751770	91	WIRE TERMINAL ROT ID5/1A 2.6SQMM 34106	4	720675
41	TUBE FLEX OD15XID12 HTR NP20 BLK FOOD GRADE	4	752116	92	FUSE 10A 10X38 DELAYED	3	780119
42	SCREW HEX M4X60 304STST DIN84A	2	747616	93	MODULE RO FT-TW30-4641HP (DRY) GRP FINISH	3	781058
43	SOCKET 1/4" OD18 L=25MM 316STST	2	w92208	94	STRAIGHT ADAPTER 1/8" BSPT-M X4MM PM010411E PL	1	751589
44	DOUBLE ADAPTER PVC 025X020X1/2" KIFV	1	950784	95	SCREW ALLEN M4X16 316STST DIN912	2	732871
45	PLUG MALE PVC 1/2" PFV	3	720561	96	PLATE 32X25X8 ANTICORODAL	4	753405
46	PRESSURE SWITCH 00.15-2A 1/8" OT PMN2AVTO.3D	1	780444	97	WASHER OD21XID10.5 316STST UNI6592	8	724675
47	PRESSURE SWITCH SUPPORT BRACKET 316STST	1	758393	98	GUIDE FOR MODULE FIXING 340X40X22 COA RAL7032	2	753407
48	GASKET 1" ASBESTOS FREE	1	753409	99	SUPPORT FOR MODULE COATED RAL7032	1	780079
49	GASKET 1/2" ASBESTOS FREE	2	753408	100	SCREW HEX M8X20 304STST DIN933	2	725345
50	SPACER OD26XID13 L19 PP	4	754069	101	CASE 66X56X162 MFP-PHARMA	1	780517

Aqua-Cleer MFP/3 1600 – 3-ph

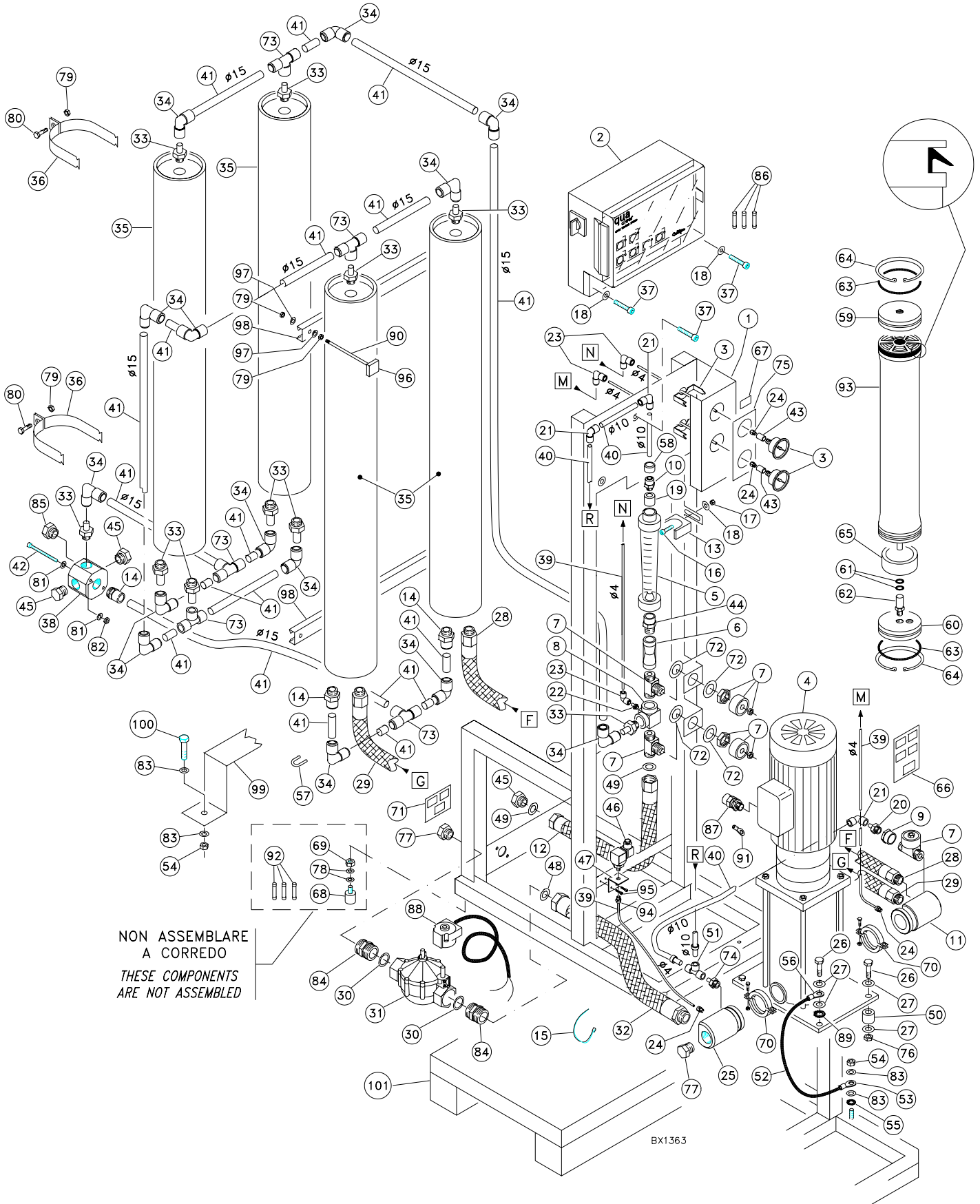

Aqua-Cleer MFP/3 1600 – 3-ph

ITEM	DESCRIPTION	QTY	CAT.NO.	ITEM	DESCRIPTION	QTY	CAT.NO.
	AQUA-CLEER MFP1600 230-380/50 3-PH C/MOD+GAB96 - CE	-	760917	51	EQUAL TEE T 10 PM0210E PL	1	751587
1	FRAME MFP/3 COATED STEEL	1	759769	52	WIRE 16 SQMM YELLOW/GREEN	0,2	747699
2	CONTROL PANEL MFP 220-240-380-415/50 3-PH	1	758990	53	WIRE TERMINAL 16 SQMM A3-M8	1	734561
3	PRESSURE GAUGE 0-25BAR OD63 REAR CONN 1/4" INOX	2	753492	54	NUT HEX M8 316STST DIN934	3	932098
4	PUMP 2P CRN02-220 2.2kW 230/380-415/50-60IP55	1	750805	55	LOCK WASHER ID8 316STST DIN6798	1	932105
5	FLOW INDICATOR DFM185 100-1000 L/H DN20 PVC	1	753416	56	WIRE TERMINAL 16 SQMM F12	1	753410
6	NON RETURN VALVE DELRIN 1/2" TYPE 290/D	1	752117	57	LOCKING CLIP OD15 CM1815S PL	44	753311
7	VALVE NEEDLE 1/2" SERTO ART 7200	3	780141	58	COLLET COVER OD10 PM1910S PL	9	753312
8	TEE SPEC 1/2"x1/4" 316STST	1	753299	59	CAP END 1" 1 HOLE WASTE	4	440989
9	SOCKET REDUCED 1/4"x1/2" PL BRASS F2553	1	721002	60	CAP END 6/4" 2 HOLES FEED/PRODUCT	4	440990
10	STRAIGHT ADAPTER 1/4"BSPT-M X T10 PM011012 PL	1	751593	61	O-RING ID 018.72/0.737" S2.62/0.103" BUNAN	8	736995
11	HEADER OUTL 1 1/2" 316STST RT MFP	1	757218	62	ADAPTER 1/2"x19.2 MOPLN	4	753469
12	HOSE FLEX 1/2"x680 M/F STST BRAIDED	1	753414	63	O-RING ID 107.44/4.230" S5.34/0.210" BUNAN	8	933657
13	PIPE CLIP PVC ID 025 REF 167.060.007	1	736129	64	SEEGER ID120 THK 2.8 DACROMET 00933659	8	933659
14	STRAIGHT ADAPTER 1/2"BSPT-M X T15 PM011514E PL	3	752112	65	SPACER PVC OD110 L75	4	753471
15	STRIP POLYAMMIDE ID1.6-33 2.4X140	20	736256	66	LABEL KIT (5 PCS)	1	753671
16	SCREW ALLEN M5X14 304STST DIN912	1	722322	67	LABEL MFP1600	1	759761
17	NUT M5 304STST DIN934	1	746412	68	VIBRATION ABSORBER RUBBER M6 OD25 P2520	4	737651
18	WASHER 304STST ID5.3XOD10	3	744075	69	NUT SELF-LOCKING M6 316STST DIN982	4	722984
19	SUPPORT FLOW METER ND20 PVC MFP	1	753309	70	CLAMP FCLC-S-48.3+OR+TDE M8X40 AISI316	2	758811
20	STEM ADAPTER 1/4" BSPT-M X T10 PM051012E PL	1	751594	71	LABEL KIT (3 PCS)	1	755311
21	EQUAL ELBOW T10 PM0310E PL	3	751588	72	WASHER BRASS 30X25X1.5 OT	4	780142
22	STEM ADAPTER 1/4" BSPT-M X T4 PM050412E PL	1	753313	73	EQUAL TEE T 15 PM215E PLAST	5	752113
23	EQUAL ELBOW T4 PM0304E PL	3	753314	74	STEM ADAPTER 3/8" T10 PM051013E PL	1	751763
24	STRAIGHT ADAPTER 1/4" BSPT-M X T4 PM010412E PL	4	739161	75	LABEL ADHESIVE PRESSURE GAUGES	1	759757
25	HEADER INL 1 1/2" 316STST RT MFP	1	757219	76	NUT HEX M12 316STST DIN934	4	w02218
26	SCREW	4	748783	77	PLUG MALE PVC 1" PFV	2	720563
27	WASHER 304STST ID13XOD24	9	716522	78	WASHER OD12.5XID6.4 304STST	8	732407
28	HOSE FLEX 1/2"x350 M/F STST BRAIDED ID16	1	753412	79	NUT HEX M10 316STST DIN934	12	724665
29	HOSE FLEX 1/2"x400 M/F STST BRAIDED ID16	1	753413	80	SCREW HEX M10X25 304STST DIN933	4	727410
30	O-RING ID 037.77/1.487" S2.62/0.109" BUNAN	2	773963	81	WASHER OD9XID4.3 316STST	4	718506
31	SOLENOID VALVE BODY 1"	1	780881	82	NUT HEX M4 316STST DIN934	2	718048
32	HOSE FLEX 1"x255 M/F STST BRAIDED ID25	1	753415	83	WASHER OD17XID8.4 304STST	6	711890
33	STEM ADAPTER 1/2" BSPT-M X T15 PM051514E PL	10	752115	84	NIPPLE BARREL PVC 1"	2	754933
34	EQUAL ELBOW T 15 PM0315E PLAST	14	752114	85	PLUG MALE PVC 3/4" PFV	1	720562
35	PRESSURE VESSEL 4.6"x47" FRP 400 PSI 00440988	4	440988	86	FUSE 6A 10X38 DELAYED	3	780117
36	COLLAR ID135 304STST PAIR 00441597	4	441597	87	CABLE GLAND SKINTOP PG16 C/W NUT AR53015040	1	757708
37	SCREW ALLEN M5X25 316STST DIN912	3	726069	88	COIL FOR SOLENOID VALVE BODY	1	780882
38	DISTRIBUTOR DELRIN FOR MFP	1	780013	89	LOCK WASHER ID12 316STST DIN6798	1	780360
39	TUBE FLEX OD4XID2 HTR NP20 BLK FOOD GRADE	4	734808	90	STUD FULL THREAD M10X150 L170	4	753406
40	TUBE FLEX OD10XID8 HTR NP15 BLK FOOD GRADE	4	751770	91	WIRE TERMINAL ROT ID5/1A 2.6SQMM 34106	4	720675
41	TUBE FLEX OD15XID12 HTR NP20 BLK FOOD GRADE	4	752116	92	FUSE 10A 10X38 DELAYED	3	780119
42	SCREW HEX M4X60 304STST DIN84A	2	747616	93	MODULE RO FT-TW30-4641HP (DRY) GRP FINISH	4	781058
43	SOCKET 1/4" OD18 L=25MM 316STST	2	w92208	94	STRAIGHT ADAPTER 1/8" BSPT-M X4MM PM010411E PL	1	751589
44	DOUBLE ADAPTER PVC 025X020X1/2" KIFV	1	950784	95	SCREW ALLEN M4X16 316STST DIN912	2	732871
45	PLUG MALE PVC 1/2" PFV	3	720561	96	PLATE 32X25X8 ANTICORODAL	4	753405
46	PRESSURE SWITCH 0.15-2A 1/8 OT PMN 2A VT 0.3D	1	780444	97	WASHER OD21XID10.5 316STST UNI6592	8	724675
47	PRESSURE SWITCH SUPPORT BRACKET 316STST	1	758393	98	GUIDE FOR MODULE FIXING 340X40X22 COA RAL7032	2	753407
48	GASKET 1" ASBESTOS FREE	1	753409	99	SUPPORT FOR MODULE COATED RAL7032	1	780079
49	GASKET 1/2" ASBESTOS FREE	2	753408	100	SCREW HEX M8X20 304STST DIN933	2	725345
50	SPACER OD26XID13 L19 PP	4	754069	101	CASE 66X56X162 MFP-PHARMA	1	780517

Aqua-Cleer MFP/3 2200 – 3-ph

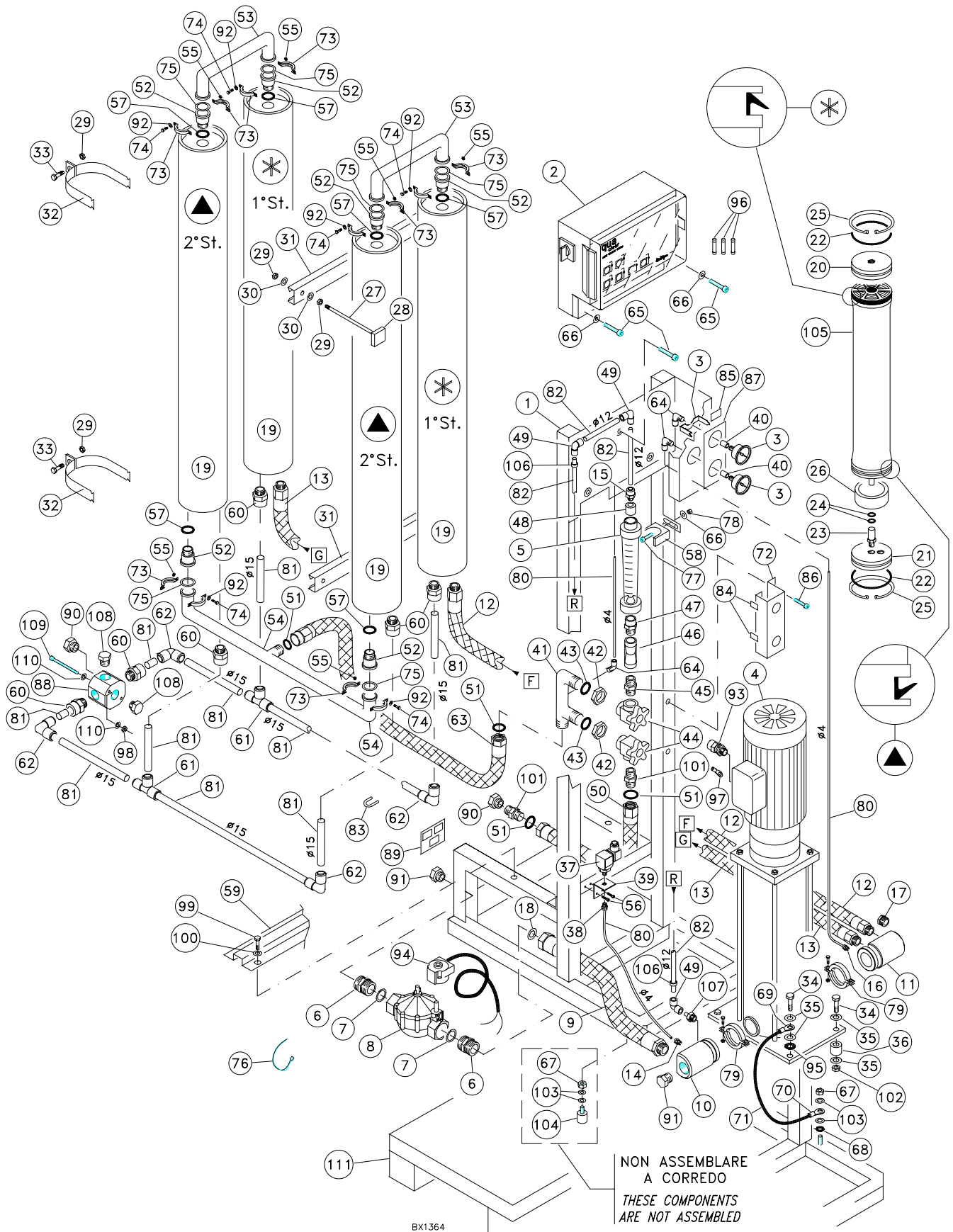

Aqua-Cleer MFP/3 2200 – 3-ph

ITEM	DESCRIPTION	QTY	CAT.NO.	ITEM	DESCRIPTION	QTY	CAT.NO.
-	AQUA-CLEER MFP 2200 230-380/50 3-PH C/MOD+GAB96 - CE	-	760918	56	SCREW ALLEN M4X16 316STST DIN912	2	732871
1	FRAME AQUA-CLEER MFP 600x500x1600 R7032 96	1	759770	57	O-RING ID021.82/0.859" S3.53/0.139" BUNAN 00333960	6	333960
2	CONTROL PANEL MFP 220-240-380-415/50 3-PH	1	758990	58	ELECT PIPE CLIP ID25 PVC	1	722434
3	PRESSURE GAUGE 0-25BAR OD63 REAR CONN 1/4" INOX	2	753492	59	SUPPORT 480X50X20 COAT RAL 7032	1	754937
4	PUMP 2P CRN04-220 4KW 230/380-415/50 3-PH	1	754348	60	STRAIGHT ADAPTER 1/2"BSPT-M X T15 PM011514E PL	6	752112
5	FLOW INDICATOR DFM200 150-1500L/H DN25 PVC	1	754883	61	EQUAL TEE T 15 PM215E PLAST	2	752113
6	NIPPLE BARREL PVC 1"	2	754933	62	EQUAL ELBOW T 15 PM0315E PLAST	4	752114
7	O-RING ID 037.77/1.487" S2.62/0.109" BUNAN	2	773963	63	HOSE FLEX 3/4"X760FF STST BRAIDED ID20	1	754878
8	SOLENOID VALVE BODY 1"	1	780881	64	L ADAPTER MALE 1/4" 316STST F2204/M	3	W95937
9	HOSE FLEX 1"X255 M/F STST BRAIDED ID25	1	753415	65	SCREW ALLEN M5X25 316STST DIN912	3	726069
10	HEADER INL 1 1/2" 316STST RT MFP	1	757219	66	WASHER 304STST ID5.3XOD10	3	744075
11	HEADER OUTL 1 1/2" 316STST RT MFP	1	757218	67	NUT HEX M8 316STST DIN934	5	932098
12	HOSE FLEX 1/2"X400 M/F STST BRAIDED ID16	1	753413	68	LOCK WASHER ID8 316STST DIN6798	1	932105
13	HOSE FLEX 1/2"X600 M/M STST BRAIDED ID16	1	754295	69	WIRE TERMINAL 16 SQMM F12	1	753410
14	STRAIGHT ADAPTER 1/4" BSPT-M X T4 PM010412E PL	1	739161	70	WIRE TERMINAL 16 SQMM A3-M8	1	734561
15	STRAIGHT ADAPTER 3/8" BSPT-M X T4 PM011213E PL	1	751591	71	WIRE 16 SQMM YELLOW/GREEN	0,2	747699
16	ADAPTER RIGHT MALE 1/4" T4 316STST F2605	1	743403	72	SUPPORT FOR MODULE 105X90X150 COA RAL7032	1	754936
17	PLUG HEX MALE 1/2" 316STST ART1137	1	W94110	73	CLAMP FCLC 26.9/30 HALF	12	754962
18	GASKET 1" ASBESTOS FREE	1	753409	74	SCREW HEX M6X25 316STST DIN933	12	722963
19	PRESSURE VESSEL 4.6"X47" FRP 400 PSI 00440988	4	440988	75	O-RING ID 24.99/0.984" S3.53/0.139" BUNAN	6	725312
20	CAP END 1" 1 HOLE WASTE	4	440989	76	STRIP POLYAMMIDE ID1.6-46 4.6X180	15	736257
21	CAP END 6/4" 2 HOLES FEED/PRODUCT	4	440990	77	SCREW ALLEN M5X14 304STST DIN912	1	722322
22	O-RING ID 107.44/4.230" S5.34/0.210" BUNAN	8	933657	78	NUT M5 304STST DIN934	1	746412
23	ADAPTER 1/2"X19.2 MOPLN	4	753469	79	CLAMP FCLC-S-48.3+OR+TDE M8X40 AISI316	2	758811
24	O-RING ID 018.72/0.737" S2.62/0.103" BUNAN	8	736995	80	TUBE FLEX OD4XID2 HTR NP20 BLK FOOD GRADE	4	734808
25	SEEGER ID120 THK 2.8 DACROMET 00933659	8	933659	81	TUBE FLEX OD15XID12 HTR NP20 BLK FOOD GRADE	4	752116
26	SPACER PVC OD110 L75	4	753471	82	TUBE FLEX OD12XID10 HTR NP12 BLK FOOD GRADE	4	751672
27	STUD FULL THREAD M10X150 L170	4	753406	83	LOCKING CLIP OD15 CM1815S PL	20	753311
28	PLATE 32X25X8 ANTICORODAL	4	753405	84	LABEL KIT (5 PCS)	1	753671
29	NUT HEX M10 316STST DIN934	12	724665	85	LABEL MFP2200	1	759762
30	WASHER OD21XID10.5 316STST UNI6592	8	724675	86	SCREW ALLEN M6X20 304STST DIN912	2	718732
31	GUIDE FOR MODULE FIXING 340X40X22 COA RAL7032	2	753407	87	LABEL ADHESIVE PRESSURE GAUGES	1	759757
32	COLLAR ID135 304STST PAIR 00441597	4	441597	88	DISTRIBUTOR DELRIN FOR MFP	1	780013
33	SCREW HEX M10X25 304STST DIN933	4	727410	89	LABEL KIT (3 PCS)	3	755311
34	SCREW	4	748783	90	PLUG MALE PVC 3/4" PFV	2	720562
35	WASHER 304STST ID13XOD24	9	716522	91	PLUG MALE PVC 1" PFV	2	720563
36	SPACER OD26XID13 L19 PP	4	754069	92	SEAL RING FCLLR M6	12	754965
37	PRESSURE SWITCH 0.15-2A 1/8 316 ST.ST. PMN 2A WVT 0.3D	1	780443	93	CABLE GLAND SKINTOP PG21 BM02I0Y+NUT BM0235R	1	780156
38	STRAIGHT ADAPTER 1/8" BSPT-M X4MM PM010411E PL	1	751589	94	COIL FOR SOLENOID VALVE BODY	1	780882
39	PRESSURE SWITCH SUPPORT BRACKET 316STST	1	758393	95	LOCK WASHER ID12 316STST DIN6798	1	780360
40	SOCKET 1/4" OD18 L=25MM 316STST	2	W92208	96	FUSE 10A 10X38 DELAYED	3	780119
41	COLLECTOR OD26.9X175 316STST	1	754867	97	WIRE TERMINAL ROT ID5/1A 2.6SQMM 34106	4	720675
42	NUT 3/4" 316STST SPEC	2	754949	98	NUT HEX M4 316STST DIN934	2	718048
43	WASHER OD35XID28 T1 PVC RED X MFP	2	754954	99	SCREW HEX M6X16 304STST DIN933	2	746422
44	NEEDLE VALVE ND 3/4"G 90DG 316STST TYPE 120	2	754674	100	WASHER OD12.5XID6.4 304STST	2	732407
45	NIPPLE PVC NFV 3/4"	1	720545	101	NIPPLE 316STST 3/4"	2	733283
46	NON RETURN VALVE DELRIN 3/4" TYPE 290/D	1	754714	102	NUT HEX M12 316STST DIN934	4	W02218
47	DOUBLE ADAPTER PVC 32X025X3/4" MF KIFV	1	934494	103	WASHER OD17XID8.4 304STST	10	711890
48	ADAPTER 32X3/8" PVC X MFP	1	754956	104	VIBRATION ABSORBER RUBBER M8 OD30 P3020	4	755186
49	EQUAL ELBOW L 12 PM0312E PL	3	751598	105	MODULE RO FT-TW30-4641HP (DRY) GRP FINISH	4	781058
50	HOSE FLEX 3/4"X760FF STST BRAIDED ID20	1	754878	106	COLLET COVER OD12 PM1912S PL	6	754977
51	GASKET 3/4" ASBESTOS FREE	4	755187	107	STEM ADAPTER 3/8" T12 PM051213E PL	1	751597
52	ADAPTER OD38X12 STST	6	754991	108	PLUG MALE PVC 1/2" PFV	2	720561
53	COLLECTOR OD21.3X142 316STST	2	754961	109	SCREW HEX M4X60 304STST DIN84A	2	747616
54	COLLECTOR OD26.9X160 316STST	1	754960	110	WASHER OD9XID4.3 316STST	4	718506
55	NUT HEX M6 316STST DIN934	12	726038	111	CARTON BOX ON WOOD BASE CM66X56X178	1	754872

Aqua-Clear MFP/3 2800 – 3-ph

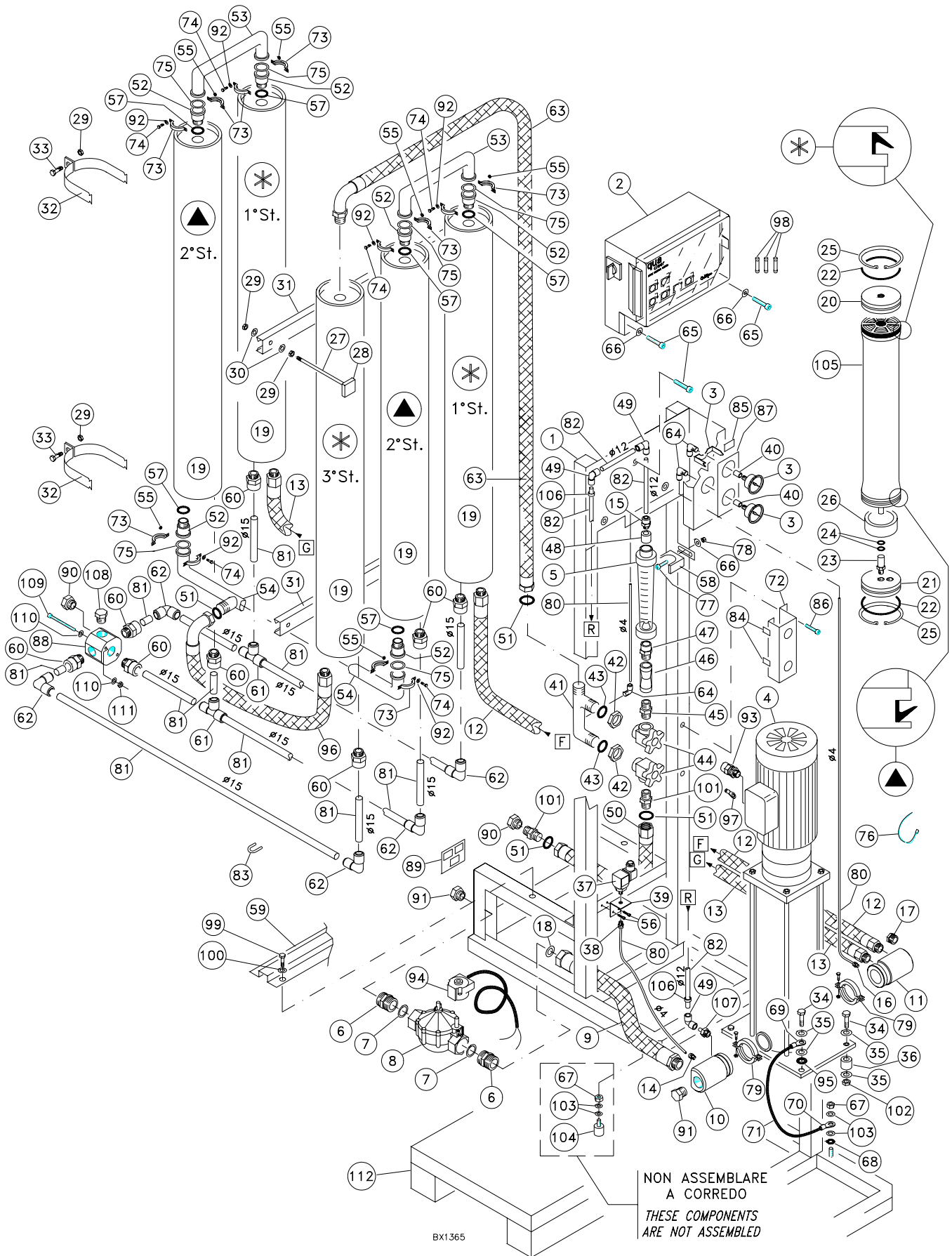

BX1365

NON ASSEMBLARE
A CORREDO
THESE COMPONENTS
ARE NOT ASSEMBLED

Aqua-Cleer MFP/3 2800 – 3-ph

ITEM	DESCRIPTION	QTY	CAT.NO.	ITEM	DESCRIPTION	QTY	CAT.NO.
-	AQUA-CLEER MFP 2800 230-380/50 3-PH C/MOD+GAB96 - CE	-	760919	57	O-RING ID021.82/0.859" S3.53/0.139" BUNAN 00333960	6	333960
1	FRAME AQUA-CLEER MFP 600x500x1600 R7032 96	1	759770	58	ELECT PIPE CLIP ID25 PVC	1	722434
2	CONTROL PANEL MFP 220-240-380-415/50 3-PH	1	758990	59	SUPPORT 480X50X20 COAT RAL 7032	1	754937
3	PRESSURE GAUGE 0-25BAR OD63 REAR CONN 1/4" INOX	2	753492	60	STRAIGHT ADAPTER 1/2"BSPT-M X T15 PM011514E PL	8	752112
4	PUMP 2P CRN04-220 4KW 220/380-415/50 3-PH	1	754348	61	EQUAL TEE T 15 PM215E PLAST	2	752113
5	FLOW INDICATOR DFM200 150-1500L/H DN25 PVC	1	754883	62	EQUAL ELBOW T 15 PM0315E PLAST	5	752114
6	NIPPLE BARREL PVC 1"	2	754933	63	HOSE FLEX 1/2"x3/4"x1060MF STST BRAIDED ID19	1	755004
7	O-RING ID 037.77/1.487" S2.62/0.109" BUNAN	2	773963	64	L ADAPTER MALE 1/4" 316STST F2204/M	3	w95937
8	SOLENOID VALVE BODY 1"	1	780881	65	SCREW ALLEN M5X25 316STST DIN912	3	726069
9	HOSE FLEX 1"x255 M/F STST BRAIDED ID25	1	753415	66	WASHER 304STST ID5.3XOD10	3	744075
10	HEADER INL 1 1/2" 316STST RT MFP	1	757219	67	NUT HEX M8 316STST DIN934	5	932098
11	HEADER OUTL 1 1/2" 316STST RT MFP	1	757218	68	LOCK WASHER ID8 316STST DIN6798	1	932105
12	HOSE FLEX 1/2"x400 M/F STST BRAIDED ID16	1	753413	69	WIRE TERMINAL 16 SQMM F12	1	753410
13	HOSE FLEX 1/2"x600 M/M STST BRAIDED ID16	1	754295	70	WIRE TERMINAL 16 SQMM A3-M8	1	734561
14	STRAIGHT ADAPTER 1/4" BSPT-M X T4 PM010412E PL	1	739161	71	WIRE 16 SQMM YELLOW/GREEN	0,2	747699
15	STRAIGHT ADAPTER 3/8" BSPT-M X T4 PM011213E PL	1	751591	72	SUPPORT FOR MODULE 105X90X150 COA RAL7032	1	754936
16	ADAPTER RIGHT MALE 1/4" T4 316STST F2605	1	743403	73	CLAMP FCLC 26.9/30 HALF	12	754962
17	PLUG HEX MALE 1/2" 316STST ART1137	1	w94110	74	SCREW HEX M6X25 316STST DIN933	12	722963
18	GASKET 1" ASBESTOS FREE	1	753409	75	O-RING ID 24.99/0.984" S3.53/0.139" BUNAN	6	725312
19	PRESSURE VESSEL 4.6"x47" FRP 400 PSI 00440988	5	440988	76	STRIP POLYAMMIDE ID1.6-46 4.6X180	15	736257
20	CAP END 1" 1 HOLE WASTE	5	440989	77	SCREW ALLEN M5X14 304STST DIN912	1	722322
21	CAP END 6/4" 2 HOLES FEED/PRODUCT	5	440990	78	NUT M5 304STST DIN934	1	746412
22	O-RING ID 107.44/4.230" S5.34/0.210" BUNAN	10	933657	79	CLAMP FCLC-S-48.3+OR+TDE M8X40 AISI316	2	758811
23	ADAPTER 1/2"x19.2 MOPLEN	5	753469	80	TUBE FLEX OD4XID2 HTR NP20 BLK FOOD GRADE	4	734808
24	O-RING ID 018.72/0.737" S2.62/0.103" BUNAN	10	736995	81	TUBE FLEX OD15XID12 HTR NP20 BLK FOOD GRADE	4	752116
25	SEEGER ID120 THK 2.8 DACROMET 00933659	10	933659	82	TUBE FLEX OD12XID10 HTR NP12 BLK FOOD GRADE	4	751672
26	SPACER PVC OD110 L75	5	753471	83	LOCKING CLIP OD15 CM1815S PL	24	753311
27	STUD FULL THREAD M10X150 L170	4	753406	84	LABEL KIT (5 PCS)	1	753671
28	PLATE 32X25X8 ANTICORODAL	4	753405	85	LABEL MFP2800	1	759763
29	NUT HEX M10 316STST DIN934	12	724665	86	SCREW ALLEN M6X20 304STST DIN912	2	718732
30	WASHER OD21XID10.5 316STST UNI6592	8	724675	87	LABEL ADHESIVE PRESSURE GAUGES	1	759757
31	GUIDE FOR MODULE FIXING 480X40X22 COA RAL7032	2	755006	88	DISTRIBUTOR DELRIN FOR MFP	1	780013
32	COLLAR ID135 304STST PAIR 00441597	4	441597	89	LABEL KIT (3 PCS)	3	755311
33	SCREW HEX M10X25 304STST DIN933	4	727410	90	PLUG MALE PVC 3/4" PFV	2	720562
34	SCREW	4	748783	91	PLUG MALE PVC 1" PFV	2	720563
35	WASHER 304STST ID13XOD24	9	716522	92	SEAL RING FCLLR M6	12	754965
36	SPACER OD26XID13 L19 PP	4	754069	93	CABLE GLAND SKINTOP PG21 BM02I0Y+NUT BM0235R	1	780156
37	PRESSURE SWITCH 0.15-2A 1/8 316 ST.ST. PMN 2A WVT 0.3D	1	780443	94	COIL FOR SOLENOID VALVE BODY	1	780882
38	STRAIGHT ADAPTER 1/8" BSPT-M X4MM PM010411E PL	1	751589	95	LOCK WASHER ID12 316STST DIN6798	1	780360
39	PRESSURE SWITCH SUPPORT BRACKET 316STST	1	758393	96	HOSE FLEX 1/2"x3/4"x560 M/F STST BRAIDED	1	755003
40	SOCKET 1/4" OD18 L=25MM 316STST	2	w92208	97	WIRE TERMINAL ROT ID5/1A 2.6SQMM 34106	4	720675
41	COLLECTOR OD26.9X175 316STST	1	754867	98	FUSE 10A 10X38 DELAYED	3	780119
42	NUT 3/4" 316STST SPEC	2	754949	99	SCREW HEX M6X16 304STST DIN933	2	746422
43	WASHER OD35XID28 T1 PVC RED X MFP	2	754954	100	WASHER OD12.5XID6.4 304STST	2	732407
44	NEEDLE VALVE ND 3/4"G 90DG 316STST TYPE 120	2	754674	101	NIPPLE 316STST 3/4"	2	733283
45	NIPPLE PVC NFV 3/4"	1	720545	102	NUT HEX M12 316STST DIN934	4	w02218
46	NON RETURN VALVE DELRIN 3/4" TYPE 290/D	1	754714	103	WASHER OD17XID8.4 304STST	10	711890
47	DOUBLE ADAPTER PVC 32X025X3/4" MF KIFV	1	934494	104	VIBRATION ABSORBER RUBBER M8 OD30 P3020	4	755186
48	ADAPTER 32X3/8" PVC X MFP	1	754956	105	MODULE RO FT-TW30-4641HP (DRY) GRP FINISH	5	781058
49	EQUAL ELBOW L 12 PM0312E PL	3	751598	106	COLLET COVER OD12 PM1912S PL	6	754977
50	HOSE FLEX 3/4"x760FF STST BRAIDED ID20	1	754878	107	STEM ADAPTER 3/8" T12 PM051213E PL	1	751597
51	GASKET 3/4" ASBESTOS FREE	4	755187	108	PLUG MALE PVC 1/2" PFV	1	720561
52	ADAPTER OD38X12 STST	6	754991	109	SCREW HEX M4X60 304STST DIN84A	2	747616
53	COLLECTOR OD21.3X142 316STST	2	754961	110	WASHER OD9XID4.3 316STST	4	718506
54	COLLECTOR OD26.9X160 316STST	1	754960	111	NUT HEX M4 316STST DIN934	2	718048
55	NUT HEX M6 316STST DIN934	12	726038	112	CARTON BOX ON WOOD BASE CM66X56X178	1	754872
56	SCREW ALLEN M4X16 316STST DIN912	2	732871				

Aqua-Cleer MFP/3 3300 – 3-ph

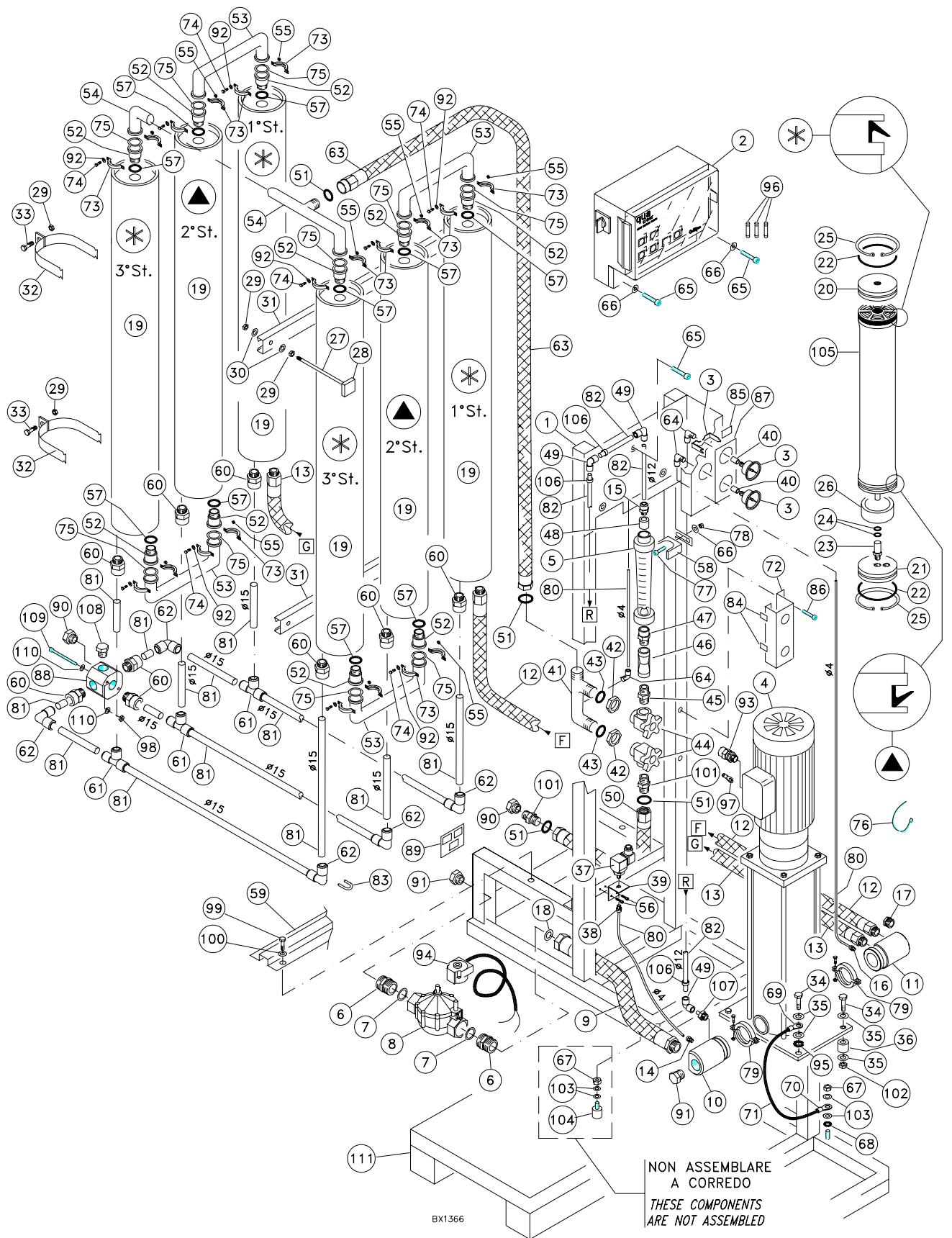

Aqua-Cleer MFP/3 3300 – 3-ph

ITEM	DESCRIPTION	QTY	CAT.NO.	ITEM	DESCRIPTION	QTY	CAT.NO.
-	AQUA-CLEER MFP 3300 230-380/50 3-PH C/MOD+GAB96 - CE	-	760920	56	SCREW ALLEN M4X16 316STST DIN912	2	732871
1	FRAME AQUA-CLEER MFP 600X500X1600 R7032 96	1	759770	57	O-RING ID021.82/0.859" S3.53/0.139" BUNAN 00333960	10	333960
2	CONTROL PANEL MFP 220-240-380-415/50 3-PH	1	758990	58	ELECT PIPE CLIP ID25 PVC	1	722434
3	PRESSURE GAUGE 0-25BAR OD63 REAR CONN 1/4" INOX	2	753492	59	SUPPORT 480X50X20 COAT RAL 7032	1	754937
4	PUMP 2P CRN04-220 4KW 220/380-415/50 3-PH	1	754348	60	STRAIGHT ADAPTER 1/2"BSPT-M X T15 PM011514E PL	9	752112
5	FLOW INDICATOR DFM200 150-1500L/H DN25 PVC	1	754883	61	EQUAL TEE T 15 PM215E PLAST	3	752113
6	NIPPLE BARREL PVC 1"	2	754933	62	EQUAL ELBOW T 15 PM0315E PLAST	5	752114
7	O-RING ID 037.77/1.487" S2.62/0.109" BUNAN	2	773963	63	HOSE FLEX 3/4"x3/4"1110FF STST BRAIDED ID20	1	755005
8	SOLENOID VALVE BODY 1"	1	780881	64	L ADAPTER MALE 1/4" 316STST F2204/M	3	w95937
9	HOSE FLEX 1"x255 M/F STST BRAIDED ID25	1	753415	65	SCREW ALLEN M5X25 316STST DIN912	3	726069
10	HEADER INL 1 1/2" 316STST RT MFP	1	757219	66	WASHER 304STST ID5.3XOD10	3	744075
11	HEADER OUTL 1 1/2" 316STST RT MFP	1	757218	67	NUT HEX M8 316STST DIN934	5	932098
12	HOSE FLEX 1/2"x400 M/F STST BRAIDED ID16	1	753413	68	LOCK WASHER ID8 316STST DIN6798	1	932105
13	HOSE FLEX 1/2"x600 M/M STST BRAIDED ID16	1	754295	69	WIRE TERMINAL 16 SQMM F12	1	753410
14	STRAIGHT ADAPTER 1/4" BSPT-M X T4 PM010412E PL	1	739161	70	WIRE TERMINAL 16 SQMM A3-M8	1	734561
15	STRAIGHT ADAPTER 3/8" BSPT-M X T4 PM011213E PL	1	751591	71	WIRE 16 SQMM YELLOW/GREEN	0,2	747699
16	ADAPTER RIGHT MALE 1/4" T4 316STST F2605	1	743403	72	SUPPORT FOR MODULE 105X90X150 COA RAL7032	1	754936
17	PLUG HEX MALE 1/2" 316STST ART1137	1	w94110	73	CLAMP FCLC 26.9/30 HALF	20	754962
18	GASKET 1" ASBESTOS FREE	1	753409	74	SCREW HEX M6X25 316STST DIN933	20	722963
19	PRESSURE VESSEL 4.6"x47" FRP 400 PSI 00440988	6	440988	75	O-RING ID 24.99/0.984" S3.53/0.139" BUNAN	10	725312
20	CAP END 1" 1 HOLE WASTE	6	440989	76	STRIP POLYAMMIDE ID1.6-46 4.6X180	15	736257
21	CAP END 6/4" 2 HOLES FEED/PRODUCT	6	440990	77	SCREW ALLEN M5X14 304STST DIN912	1	722322
22	O-RING ID 107.44/4.230" S5.34/0.210" BUNAN	12	933657	78	NUT M5 304STST DIN934	1	746412
23	ADAPTER 1/2"x19.2 MOPLN	6	753469	79	CLAMP FCLC-S-48.3+OR+TDE M8X40 AISI316	2	758811
24	O-RING ID 018.72/0.737" S2.62/0.103" BUNAN	12	736995	80	TUBE FLEX OD4XID2 HTR NP20 BLK FOOD GRADE	4	734808
25	SEGER ID120 THK 2.8 DACROMET 00933659	12	933659	81	TUBE FLEX OD15XID12 HTR NP20 BLK FOOD GRADE	4	752116
26	SPACER PVC OD110 L75	6	753471	82	TUBE FLEX OD12XID10 HTR NP12 BLK FOOD GRADE	4	751672
27	STUD FULL THREAD M10X150 L170	4	753406	83	LOCKING CLIP OD15 CM1815S PL	30	753311
28	PLATE 32X25X8 ANTICORODAL	4	753405	84	LABEL KIT (5 PCS)	1	753671
29	NUT HEX M10 316STST DIN934	14	724665	85	LABEL MFP3300	1	759764
30	WASHER OD21XID10.5 316STST UNI6592	8	724675	86	SCREW ALLEN M6X20 304STST DIN912	2	718732
31	GUIDE FOR MODULE FIXING 480X40X22 COA RAL7032	2	755006	87	LABEL ADHESIVE PRESSURE GAUGES	1	759757
32	COLLAR ID135 304STST PAIR 00441597	6	441597	88	DISTRIBUTOR DELRIN FOR MFP	1	780013
33	SCREW HEX M10X25 304STST DIN933	6	727410	89	LABEL KIT (3 PCS)	3	755311
34	SCREW	4	748783	90	PLUG MALE PVC 3/4" PFV	2	720562
35	WASHER 304STST ID13XOD24	9	716522	91	PLUG MALE PVC 1" PFV	2	720563
36	SPACER OD26XID13 L19 PP	4	754069	92	SEAL RING FCLLR M6	20	754965
37	PRESSURE SWITCH 0.15-2A 1/8 316 ST.ST. PMN 2A WVT 0.3D	1	780443	93	CABLE GLAND SKINTOP PG21 BM0210Y+NUT BM0235R	1	780156
38	STRAIGHT ADAPTER 1/8" BSPT-M X4MM PM010411E PL	1	751589	94	COIL FOR SOLENOID VALVE BODY	1	780882
39	PRESSURE SWITCH SUPPORT BRACKET 316STST	1	758393	95	LOCK WASHER ID12 316STST DIN6798	1	780360
40	SOCKET 1/4" OD18 L=25MM 316STST	2	w92208	96	FUSE 10A 10X38 DELAYED	3	780119
41	COLLECTOR OD26.9X175 316STST	1	754867	97	WIRE TERMINAL ROT ID5/1A 2.6SQMM 34106	4	720675
42	NUT 3/4" 316STST SPEC	2	754949	98	NUT HEX M4 316STST DIN934	2	718048
43	WASHER OD35XID28 T1 PVC RED X MFP	2	754954	99	SCREW HEX M6X16 304STST DIN933	2	746422
44	NEEDLE VALVE ND 3/4"G 90DG 316STST TYPE 120	2	754674	100	WASHER OD12.5XID6.4 304STST	2	732407
45	NIPPLE PVC NFV 3/4"	1	720545	101	NIPPLE 316STST 3/4"	2	733283
46	NON RETURN VALVE DELRIN 3/4" TYPE 290/D	1	754714	102	NUT HEX M12 316STST DIN934	4	w02218
47	DOUBLE ADAPTER PVC 32X025X3/4" MF KIFV	1	934494	103	WASHER OD17XID8.4 304STST	10	711890
48	ADAPTER 32X3/8" PVC X MFP	1	754956	104	VIBRATION ABSORBER RUBBER M8 OD30 P3020	4	755186
49	EQUAL ELBOW L 12 PM0312E PL	3	751598	105	MODULE RO FT-TW30-4641HP (DRY) GRP FINISH	6	781058
50	HOSE FLEX 3/4"x760FF STST BRAIDED ID20	1	754878	106	COLLET COVER OD12 PM1912S PL	6	754977
51	GASKET 3/4" ASBESTOS FREE	4	755187	107	STEM ADAPTER 3/8" T12 PM051213E PL	1	751597
52	ADAPTER OD38X12 STST	10	754991	108	PLUG MALE PVC 1/2" PFV	1	720561
53	COLLECTOR OD21.3X142 316STST	4	754961	109	SCREW HEX M4X60 304STST DIN84A	2	747616
54	COLLECTOR OD26.9X160 316STST	1	754960	110	WASHER OD9XID4.3 316STST	4	718506
55	NUT HEX M6 316STST DIN934	20	726038	111	CARTON BOX ON WOOD BASE CM66X56X178	1	754872

CRN 2 – 150 – 3-ph MOTOR PUMP for MFP/3 400
CRN 2 – 180 – 3-ph MOTOR PUMP for MFP/3 800, 1200
CRN 2 – 220 – 3-ph MOTOR PUMP for MFP/3 1600

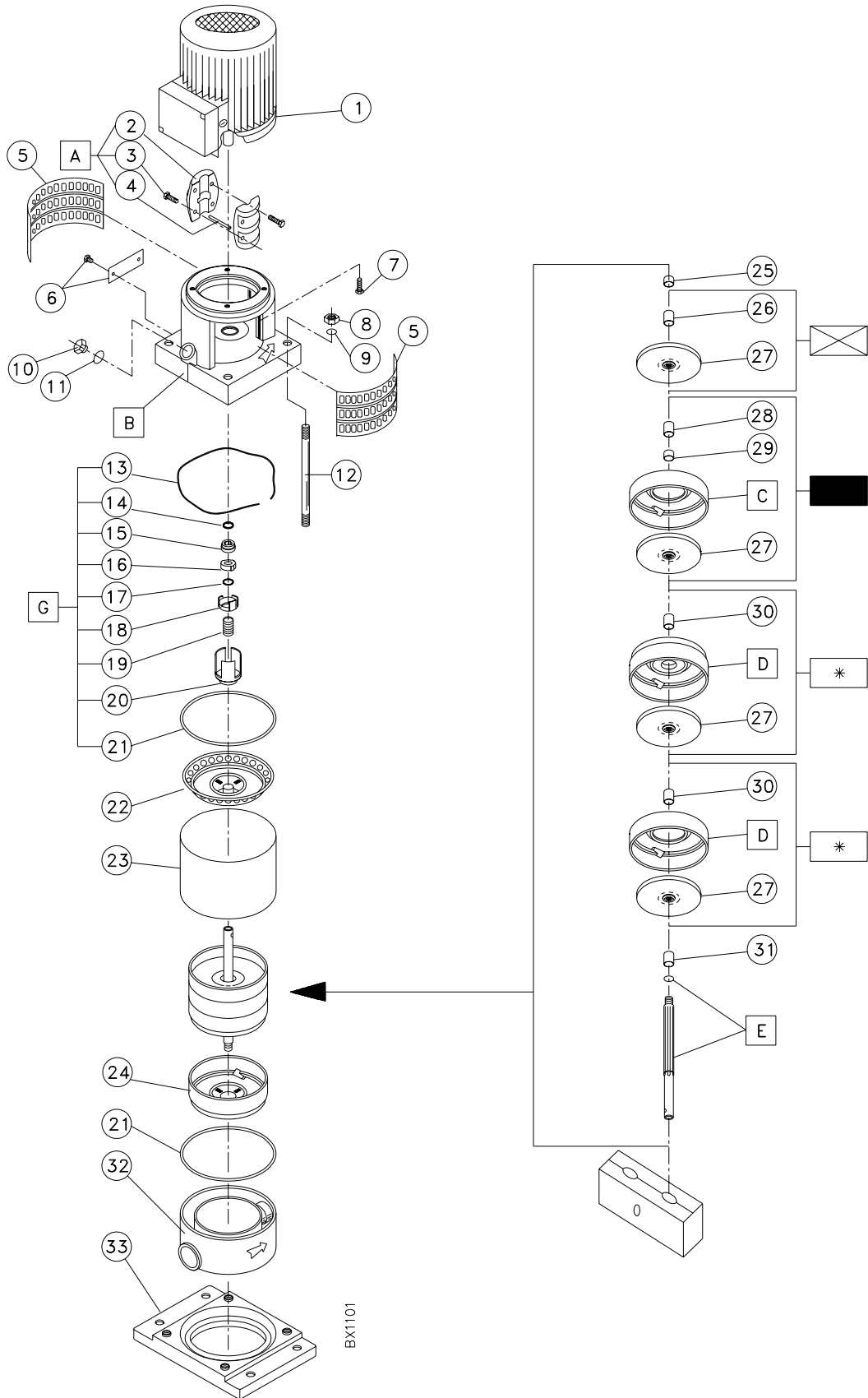

CRN 2 – 150 – 3-ph MOTOR PUMP for MFP/3 400
CRN 2 – 180 – 3-ph MOTOR PUMP for MFP/3 800, 1200, 1600
CRN 2 – 220 – 3-ph MOTOR PUMP for MFP/3 1600

ITEM	DESCRIPTION	MFP/3 400		MFP/3 800, 1200, 1600	
		Q.TY	CAT. NO.	Q.TY	CAT. NO.
-	PUMP AND MOTOR 230/380V-50Hz-3-PH	1	7596-16	1	7596-17
1	MOTOR 230/380V – 50 HZ - 3 PH	1	7803-75	-	7803-74
2	COUPLING GUARD (FOR PARTS KIT)	2	A	2	A
3	SCREW	4	A	4	A
4	SHAFT PIN (FOR PARTS KIT)	1	A	1	A
5	COUPLING GUARD (NO CODIFICATION)	2	B	1	B
6	IDENTIFICATION PLAID (NO CODIFICATION)	1	B	1	B
7	SCREW (NO CODIFICATION)	4	B	4	B
8	NUT (NO CODIFICATION)	4	B	4	B
9	WASHER (NO CODIFICATION)	4	B	4	B
10	PLUG (NO CODIFICATION)	1	B	1	B
11	O-RING (NO CODIFICATION)	1	B	1	B
12	STAY BOLT	4	7289-17	4	7289-18
13	CORRUGATED SPRING (FOR PARTS KITS)	1	G	1	G
14	O-RING (FOR PARTS KITS)	1	G	1	G
15	UPPER SEAL RING (FOR PARTS KITS)	1	G	1	G
16	LOWER SEAL RING (FOR PARTS KITS)	1	G	1	G
17	O-RING (FOR PARTS KITS)	1	G	1	G
18	UPPER SEAL DRIVER (FOR PARTS KITS)	1	G	1	G
19	SPRING (FOR PARTS KITS)	1	G	1	G
20	LOWER SEAL DRIVER (FOR PARTS KITS)	1	G	1	G
21	GASKET (FOR PARTS KITS)	2	G	2	G
22	TOP GUIDE VANE (NO CODIFICATION)	-	-	-	-
23	OUTER SLEEVE	1	7289-47	1	7289-48
24	INTERMEDIATE CHAMBER LOWER	1	7289-10	1	7289-10
25	NUT (NO CODIFICATION)				
26	SPACER (FOR PARTS KITS)	-	H	-	H
27	IMPELLER	15	7289-43	18	7289-43
28	SPACER (NO CODIFICATION)	-	-	-	-
29	SPACER (REPAIR KIT FOR PUMP)	-	H	-	H
30	SPACER (REPAIR KIT FOR PUMP)	-	-	-	-
31	SPACER (NO CODIFICATION)	-	-	-	-
32	BASE (NO CODIFICATION)	-	-	-	-
33	BASE PLATE (NO CODIFICATION)	-	-	-	-
REPAIR FOR PUMP KIT					
A	COUPLING COMPLETE (N.7-6-5) (NO CODIFICATION)	-	-	-	-
B	PUMP NEED COMPLETE (N. 5-6-7-8-9-10-11)	1	7369-07	1	7369-07
C	INTERMEDIATE CHAMBER WITH BEARING (INCLUDED KIT "H")	2	-	2	-
D	INTERMEDIATE CHAMBER	12	7289-08	15	7289-08
E	BEARING RING ASSLY	1	7289-45	1	7289-46
G	MECHANICAL SEAL (ASSLY) (N. 13-14-15-16-17-18-19-20-21)	1	7289-67	1	7289-67
H	REPAIR FOR PUMP - PARTS (N. 26 - 29 - 30 E C)	1	7551-44	1	7551-44

CONTROL PANEL for MFP/3

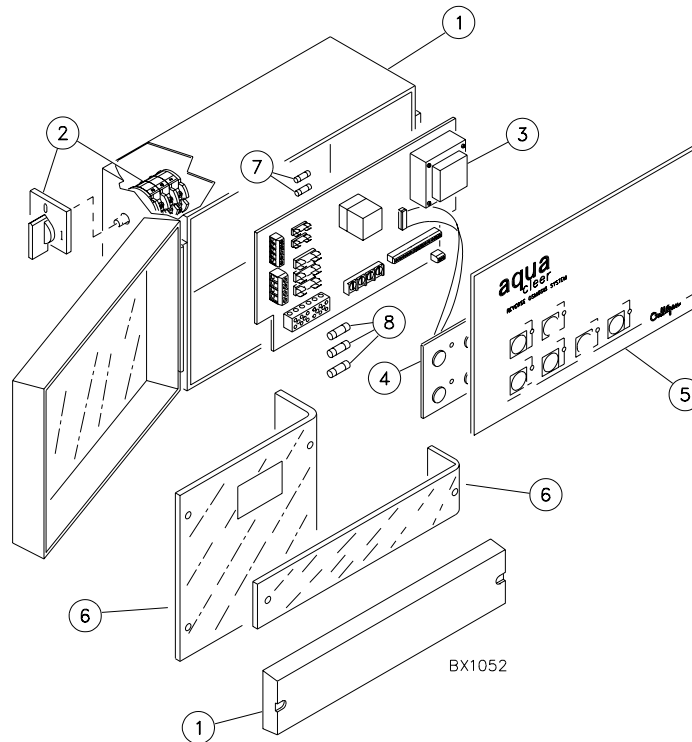

ITEM	DESCRIPTION	Q.TY	CAT. NO.
-	CONTROL PANEL 220/240/380/415 V	-	7589-90
1	PLASTIC CASE	1	7803-61
2	MAIN SWITCH	1	7803-58
3	POWER BOARD	1	7803-59
4	CPU BOARD	1	7803-57
5	FRONT PANEL	1	7803-56
6	PROTECTION AND LABEL KIT	1	7803-55
7	FUSE 500 MA 5X20	2	7320-98

FUSES (ITEM 8)

MFP/3 MODEL	230/50 – 3-PH				380/50 – 3-PH				220/50 – 1-PH			
	KW PUMP	FUSE AMPERE	CAT. NO.	Q.TY	KW PUMP	FUSE AMPERE	CAT. NO.	Q.TY	KW PUMP	FUSE AMPERE	CAT. NO.	Q.TY
400	1.5	8A	7801-18	3	1.5	4A	7801-16	3	1.5	10A	7801-19	2
800	2.2	10A	7801-19	3	2.2	6A	7801-17	3	2.2	16A	7801-20	2
1200	2.2	10A	7801-19	3	2.2	6A	7801-17	3	2.2	16A	7801-20	2
1600	2.2	10A	7801-19	3	2.2	6A	7801-17	3	2.2	16A	7801-20	2
2200					4	10A	7801-19	3				
2800					4	10A	7801-19	3				
3300					4	10A	7801-19	3				

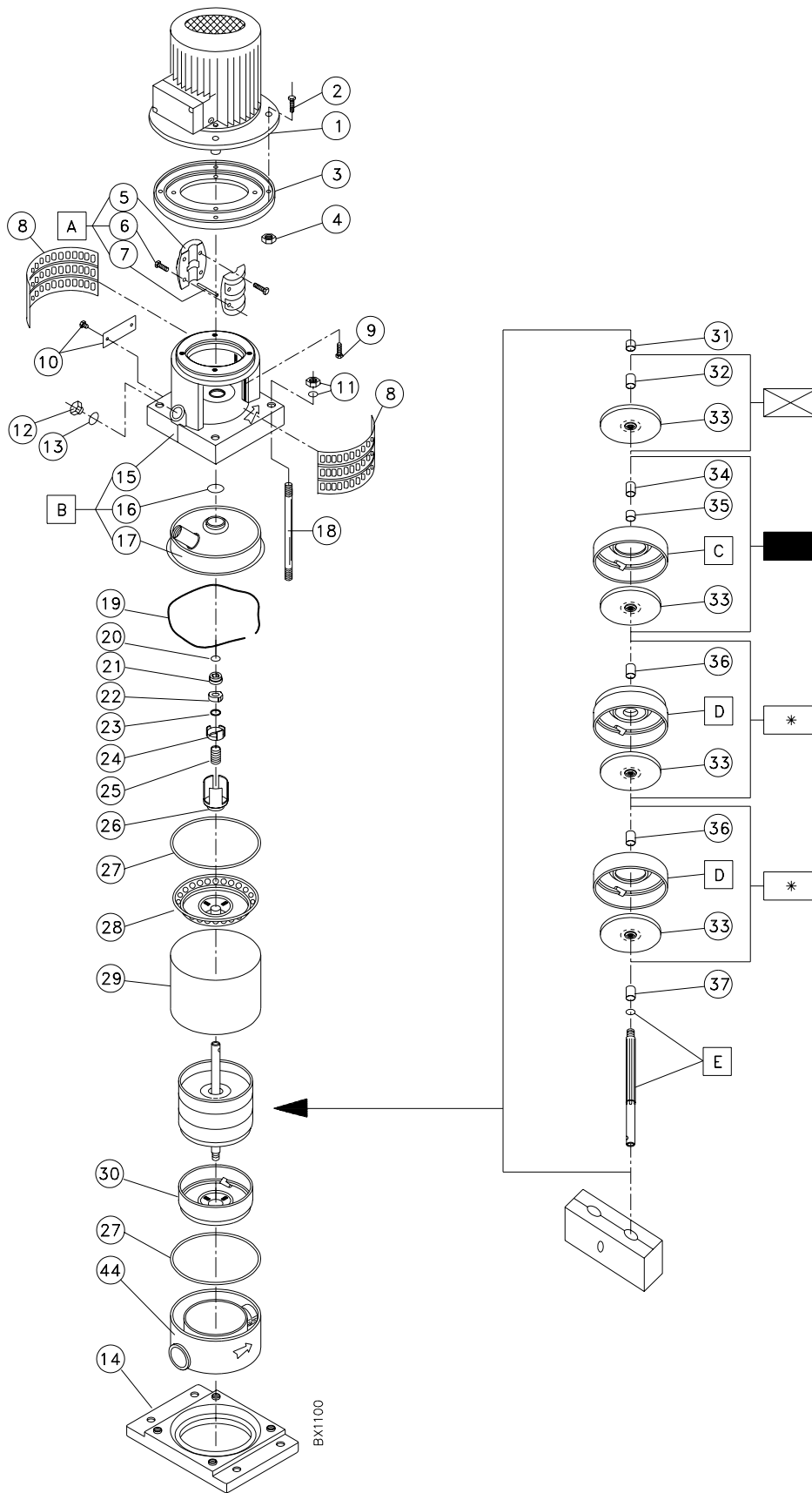

CRN 4 – 220 – 3-ph MOTOR PUMP for MFP/3 2200, 2800, 3300



CRN 4 – 220 – 3-ph MOTOR PUMP for MFP/3 2200, 2800, 3300



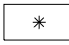

















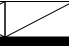

ITEM	DESCRIPTION	Q.TY	CAT. NO.
-	PUMP AND MOTOR 230/380V-50HZ-3-PH	1	7543-48
1	MOTOR 230/380V – 50 Hz – 3-PH	1	7803-76
2	SCREW (NO CODIFICATION)	4	-
3	FLANGED (NO CODIFICATION)	1	-
4	NUT (NO CODIFICATION)	4	-
5	COUPLING GUARD (FOR PARTS KIT)	2	A
6	SCREW (FOR PARTS KIT)	4	A
7	SHAFT PIN (FOR PARTS KIT)	1	A
8	COUPLING GUARD (FOR PARTS KIT)	1	B
9	SCREW (FOR PARTS KIT)	4	B
10	IDENTIFICATION PLAIT (FOR PARTS KIT)	1	B
11	NUT (NO CODIFICATION)	4	-
12	PLUG (FOR PARTS KIT)	1	B
13	O-RING (FOR PARTS KIT)	1	B
14	BASE PLATE (NO CODIFICATION)	-	-
15	PUMP HEAD (FOR PARTS KITS)	1	B
16	O-RING (FOR PARTS KITS)	1	B
17	PUMP HEAD COVER (FOR PARTS KITS)	1	B
18	STAY BOLT	4	7551-55
19	CORRUGATED SPRING (FOR PARTS KITS)	-	G
20	O-RING (FOR PARTS KITS)	-	G
21	UPPER SEAL RING (FOR PARTS KITS)	-	G
22	LOWER SEAL RING (FOR PARTS KITS)	-	G
23	O-RING (FOR PARTS KITS)	-	G
24	UPPER SEAL DRIVER (FOR PARTS KITS)	-	G
25	SPRING (FOR PARTS KITS)	-	G
26	LOWER SEAL DRIVER (FOR PARTS KITS)	-	G
27	GASKET (FOR PARTS KITS)	-	G
28	TOP GUIDE VANE (NO CODIFICATION)	-	-
29	OUTER SLEEVE	1	7551-59
30	INTERMEDIATE CHAMBER LOWER	1	7551-60
31	NUT (NO CODIFICATION)	-	-
32	SPACER (FOR PARTS KITS)	-	H
33	IMPELLER	22	7551-61
34	SPACER (NO CODIFICATION)	-	-
35	SPACER (FOR PARTS KITS)	-	H
36	SPACER (NO CODIFICATION)	-	-
37	SPACER (FOR PARTS KITS)	-	F
38	BASE (NO CODIFICATION)	-	-
REPAIR FOR PUMP KIT			
A	COUPLING COMPLETE (N.7-6-5) (NO CODIFICATION)	-	-
B	PUMP NEED COMPLETE (N.8-9-10-12-13-14-15-16-17)	1	7369-07
C	INTERMEDIATE CHAMBER WITH BEARING (INCLUDED KIT "H")	2	-
D	INTERMEDIATE CHAMBER	17	7551-62
E	BEARING RING ASSLY	1	7551-63
G	MECHANICAL SEAL (ASSLY) (N. 19-20-21-22-23-24-25-26-27)	1	7289-67
H	REPAIR FOR PUMP - PARTS (N. 26 - 29 - 30 E C)	1	7551-65

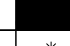
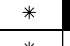
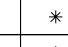
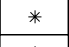
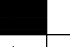
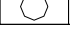
THE ASSEMBLY OF THE PUMP IS ILLUSTRATED IN THE TABLE BY SYMBOLS
 IL MONTAGGIO DELLA POMPA È ILLUSTRATO NELLA TABELLA TRAMITE SIMBOLI

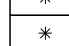
- 2 x  Pos. 49 – 4- 64
- 1 x  Pos. 49 – 4- 64
- 1 x  Pos. 49 – 4- 64

See drawing on page 19
 Vedi disegno a pag. 19

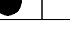
CRN 4

20/1	20	30	40	50	60	80/7	80	100	120	160 /14	160	190	220
													
													
	*	*	*	*	*	*	*	*	*	*	*	*	*
		*	*	*	*	*	*	*	*	*	*	*	*
			*	*		*	*	*	*	*		*	*
				*	*	*	*	*	*	*	*	*	*
					*	*		*			*	*	*
						*	*	*	*	*	*	*	
						*		*	*	*	*	*	*
							*	*	*	*		*	*
								*	*	*	*	*	*
									*	*		*	
										*	*	*	*
											*	*	*
											*		*
												*	*
												*	*
												*	
													*
													*
													*

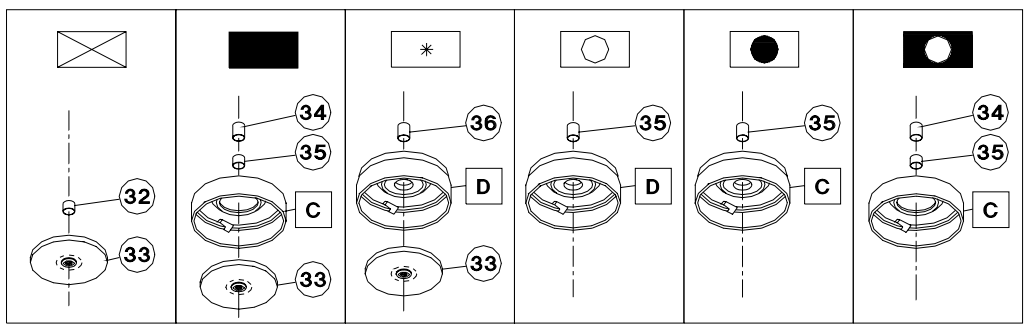
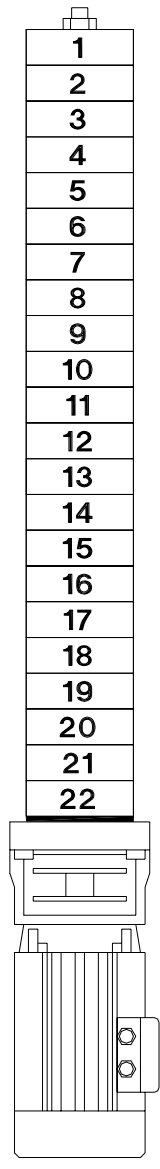

BX1437

Order of assembly
 Sequenza di assemblaggio

Part numbers and descriptions, see "Parts list"
 Numeri di catalogo e descrizioni, vedi lista "Parti di ricambio"

**MODULE RO-FT 30 for MFP 400-800-1200
1600-2200-2800-3300**

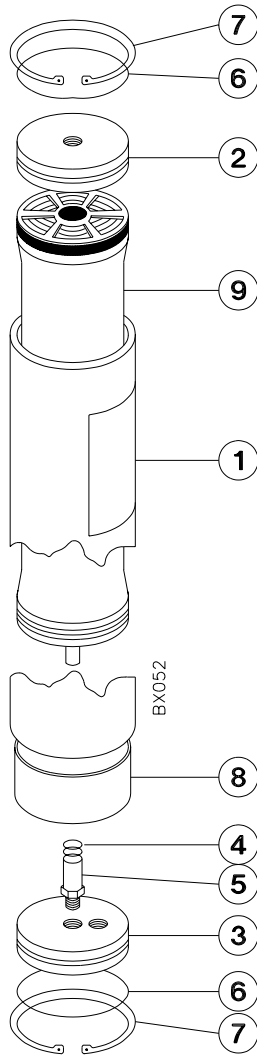

24

ITEM	DESCRIPTION	Q.TY	CAT. NO.
-	MODULE ASSLY FOR MFP/3	-	7810-71
1	VESSEL FIBERGLASS	1	4409-88
2	CAP END 1" HOLE WASTE	1	4409-89
3	CAP END 6/4" HOLES	1	4409-90
4	O-RING	2	7369-95
5	ADAPTER 1/2"	1	7534-69
6	O-RING	2	9336-57
7	RING SNAP	2	9336-59
8	SPACER PVC	1	7534-71
9	MODULE RO FT TW	1	7810-58

OPTIONAL TEST KIT

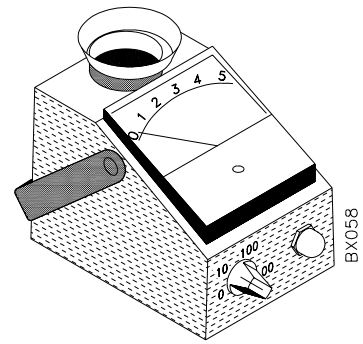

T.D.S. METER – Cat. No. 4705-04

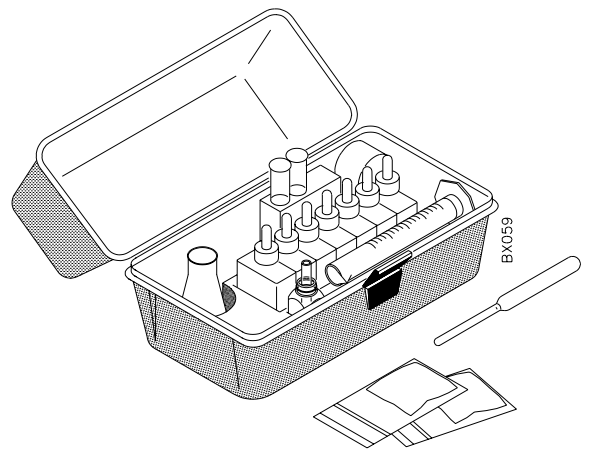

NEW WATER PROBLEM - Cat. No. 7502-

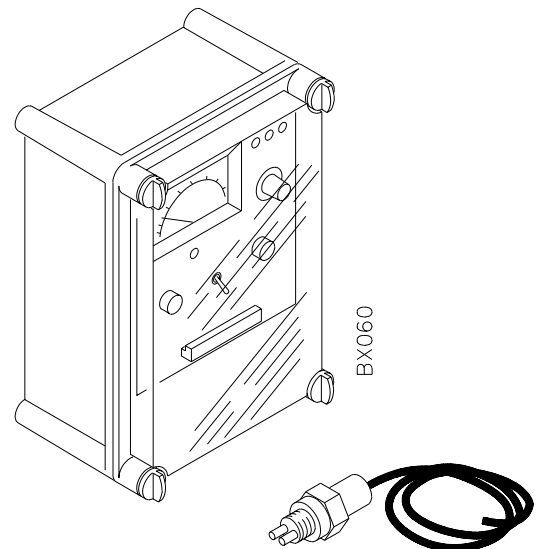

**CONDUCTIVITY METERS
C100-WP91E 0-100 230V-50Hz
Cat. No. 7569-93**

RAPID PIPE FITTING

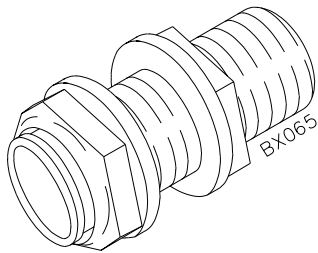

DESCRIPTION	CAT. No.
BULKEHEAD CONNECTOR EXT. DIA. 4 MM	-
BULKEHEAD CONNECTOR EXT. DIA. 5 MM	-
BULKEHEAD CONNECTOR EXT. DIA. 6 MM	7376-44
BULKEHEAD CONNECTOR EXT. DIA. 8 MM	7391-59
BULKEHEAD CONNECTOR EXT. DIA. 10 MM	7376-43
BULKEHEAD CONNECTOR EXT. DIA. 12 MM	-

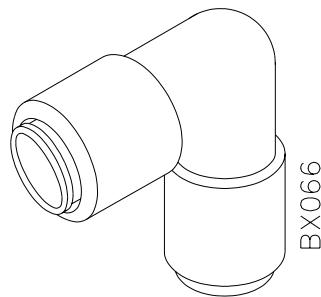

DESCRIPTION	CAT. No.
EQUAL ELBOW CONNECTOR FOR TUBING DIA. 4 MM	7533-14
EQUAL ELBOW CONNECTOR FOR TUBING DIA. 5 MM	-
EQUAL ELBOW CONNECTOR FOR TUBING DIA. 6 MM	7376-48
EQUAL ELBOW CONNECTOR FOR TUBING DIA. 8 MM	7391-21
EQUAL ELBOW CONNECTOR FOR TUBING DIA. 10 MM	7515-88
EQUAL ELBOW CONNECTOR FOR TUBING DIA. 12 MM	7515-98
EQUAL ELBOW CONNECTOR FOR TUBING DIA. 15 MM	7521-14
EQUAL ELBOW CONNECTOR FOR TUBING DIA. 18 MM	-

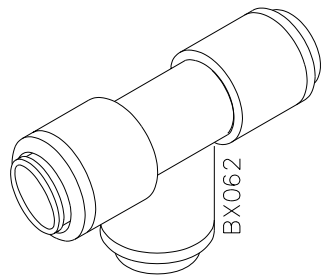

DESCRIPTION	CAT. No.
EQUAL TEE CONNECTOR FOR TUBING DIA. 4 MM	-
EQUAL TEE CONNECTOR FOR TUBING DIA. 5 MM	-
EQUAL TEE CONNECTOR FOR TUBING DIA. 6 MM	7390-33
EQUAL TEE CONNECTOR FOR TUBING DIA. 8 MM	7391-57
EQUAL TEE CONNECTOR FOR TUBING DIA. 10 MM	7515-87
EQUAL TEE CONNECTOR FOR TUBING DIA. 12 MM	-
EQUAL TEE CONNECTOR FOR TUBING DIA. 15 MM	7521-13
EQUAL TEE CONNECTOR FOR TUBING DIA. 18 MM	-

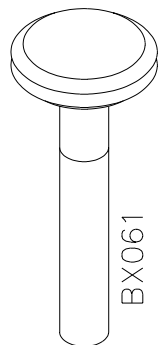

DESCRIPTION	CAT. No.
PLUG FOR TUBING DIA. 4 MM	7391-56
PLUG FOR TUBING DIA. 5 MM	-
PLUG FOR TUBING DIA. 6 MM	7394-73
PLUG FOR TUBING DIA. 8 MM	-
PLUG FOR TUBING DIA. 10 MM	-
PLUG FOR TUBING DIA. 12 MM	-
PLUG FOR TUBING DIA. 15 MM	-
PLUG FOR TUBING DIA. 18 MM	-

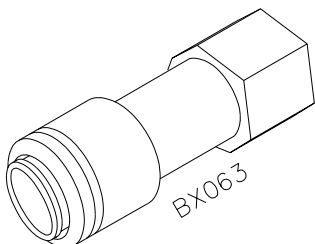

DESCRIPTION	CAT. No.
FEMALE ADAPTER FOR TUBING DIA. 4 MM X 1/8"	7540-71
FEMALE ADAPTER FOR TUBING DIA. 6 MM X 1/8"	-
FEMALE ADAPTER FOR TUBING DIA. 8 MM X 1/4"	7391-60
FEMALE ADAPTER FOR TUBING DIA. 8 MM X 1/4"	-
FEMALE ADAPTER FOR TUBING DIA. 8 MM X 1/2"	-

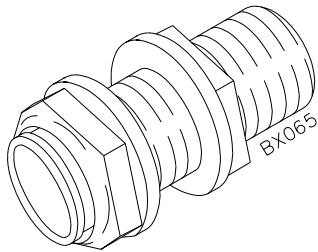

DESCRIPTION	CAT. No.
REDUCER TUBING DIA. 5 - DIA. 4	-
REDUCER TUBING DIA. 6 - DIA. 4	-
REDUCER TUBING DIA. 6 - DIA. 5	-
REDUCER TUBING DIA. 8 - DIA. 4	7391-65
REDUCER TUBING DIA. 8 - DIA. 5	-
REDUCER TUBING DIA. 8 - DIA. 6	7391-58
REDUCER TUBING DIA. 10 - DIA. 6	7376-42
REDUCER TUBING DIA. 10 - DIA. 8	-
REDUCER TUBING DIA. 12 - DIA. 8	-
REDUCER TUBING DIA. 12 - DIA. 10	-
REDUCER TUBING DIA. 15 - DIA. 10	7515-95
REDUCER TUBING DIA. 15 - DIA. 12	-
REDUCER TUBING DIA. 18 - DIA. 15	-

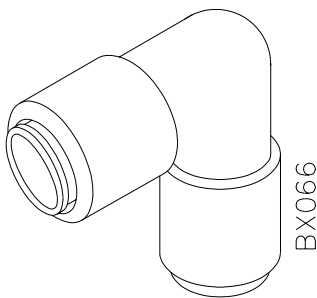

DESCRIPTION	CAT. No.
STRAIGHT ADAPTER FOR TUBING DIA. 4 MM X 1/8"	7515-89
STRAIGHT ADAPTER FOR TUBING DIA. 4 MM X 1/4"	7391-61
STRAIGHT ADAPTER FOR TUBING DIA. 5 MM X 1/8"	-
STRAIGHT ADAPTER FOR TUBING DIA. 5 MM X 1/4"	-
STRAIGHT ADAPTER FOR TUBING DIA. 6 MM X 1/8"	-
STRAIGHT ADAPTER FOR TUBING DIA. 6 MM X 1/4"	7390-34
STRAIGHT ADAPTER FOR TUBING DIA. 8 MM X 1/8"	-
STRAIGHT ADAPTER FOR TUBING DIA. 8 MM X 1/4"	7392-19
STRAIGHT ADAPTER FOR TUBING DIA. 8 MM X 3/8"	7515-24
STRAIGHT ADAPTER FOR TUBING DIA. 10 MM X 1/4"	7515-93
STRAIGHT ADAPTER FOR TUBING DIA. 10 MM X 3/8"	7515-90
STRAIGHT ADAPTER FOR TUBING DIA. 10 MM X 1/2"	-
STRAIGHT ADAPTER FOR TUBING DIA. 12 MM X 3/8"	7515-91
STRAIGHT ADAPTER FOR TUBING DIA. 12 MM X 1/2"	-
STRAIGHT ADAPTER FOR TUBING DIA. 15 MM X 1/2"	7521-12
STRAIGHT ADAPTER FOR TUBING DIA. 18 MM X 1/2"	-

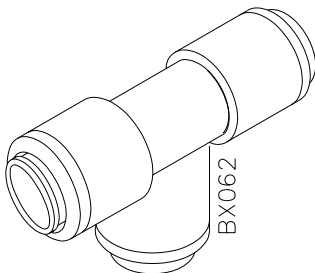

DESCRIPTION	CAT. No.
STEM ADAPTER FOR TUBING DIA. 4 X 1/8"	-
STEM ADAPTER FOR TUBING DIA. 4 X 1/4"	7533-13
STEM ADAPTER FOR TUBING DIA. 5 X 1/8"	-
STEM ADAPTER FOR TUBING DIA. 5 X 1/4"	-
STEM ADAPTER FOR TUBING DIA. 6 X 1/8"	7520-25
STEM ADAPTER FOR TUBING DIA. 6 X 1/4"	7376-49
STEM ADAPTER FOR TUBING DIA. 8 X 1/8"	-
STEM ADAPTER FOR TUBING DIA. 8 X 1/4"	7391-55
STEM ADAPTER FOR TUBING DIA. 8 X 3/8"	7391-63
STEM ADAPTER FOR TUBING DIA. 10 X 1/4"	7515-94
STEM ADAPTER FOR TUBING DIA. 10 X 3/8"	7517-63
STEM ADAPTER FOR TUBING DIA. 10 X 1/2"	-
STEM ADAPTER FOR TUBING DIA. 12 X 3/8"	7515-97
STEM ADAPTER FOR TUBING DIA. 12 X 1/2"	-
STEM ADAPTER FOR TUBING DIA. 15 X 3/8"	-
STEM ADAPTER FOR TUBING DIA. 15 X 1/2"	7521-15
STEM ADAPTER FOR TUBING DIA. 18 X 1/2"	-

NOTE = HOSES ARE IDENTIFIED AS FOLLOWS:

OD	=	4 MM	CAT. 7348-08
OD	=	6 MM	CAT. 7478-60
OD	=	8 MM	CAT. 7348-12
OD	=	10 MM	CAT. 7517-70
OD	=	12 MM	CAT. 7516-72
OD	=	15 MM	CAT. 7521-16

STATE REQUIRED LENGTH ORDERING